



April 9, 2009

TO: Members of the Board of Regents
Ex-officio Representatives to the Board of Regents

FROM: Joan Goldblatt, Secretary of the Board of Regents

RE: Preliminary Schedule of Meetings
Special Meeting of the Board

THURSDAY, APRIL 16, 2009

Note: Committees will meet concurrently.

10:15 to 11:15 a.m.	UW Tower 22nd Floor Board Room	FINANCE, AUDIT AND FACILITIES COMMITTEE: Regents Blake (Chr), Brotman, Jewell, Kiga, Simon
10:15 to 11:15 a.m.	UW Tower 22nd Floor Glass Room	ACADEMIC & STUDENT AFFAIRS COMMITTEE: Regents Simon (Chr), Barer, Gates, Proctor, Willynck
11:30 a.m.	UW Tower 22nd Floor Board Room	SPECIAL MEETING OF BOARD OF REGENTS

To request disability accommodation, contact the Disability Services Office at: 206.543.6450 (voice), 206.543.6452 (TTY), 206.685.7264 (fax), or email at dso@u.washington.edu. The University of Washington makes every effort to honor disability accommodation requests. Requests can be responded to most effectively if received as far in advance of the event as possible, preferably at least 10 days.



**UNIVERSITY OF WASHINGTON
BOARD OF REGENTS
SPECIAL MEETING**

Academic and Student Affairs Committee
Regents Simon (Chair), Barer, Gates, Proctor, Willynck

**April 16, 2009
10:15 to 11:15 a.m.
UW Tower
22nd Floor, Glass Room**

- | | | | |
|----|---|--------------------|-----|
| 1. | Academic and Administrative Appointments
Phyllis M. Wise, Provost and Executive Vice President | ACTION | A-1 |
| 2. | Tri-Campus Update
Phyllis M. Wise
Doug Wadden, Executive Vice President
Kenyon Chan, Chancellor, UW Bothell
Patricia Spakes, Chancellor, UW Tacoma | INFORMATION | A-2 |
| 3. | An Invitation from the Faculty Senate to Visit Sites of Campus Research
Bruce Balick, Professor of Astronomy and Vice Chair of the Faculty Senate | INFORMATION | A-3 |



**UNIVERSITY OF WASHINGTON
BOARD OF REGENTS
SPECIAL MEETING**

Finance, Audit and Facilities Committee
Regents Blake (Chair), Brotman, Jewell, Kiga, Simon

**April 16, 2009
10:15 to 11:15 a.m.
UW Tower
22nd Floor, Board Room**

- | | | | |
|----|---|--------------------|-----|
| 1. | Grant and Contract Awards – January and February, 2009
Phyllis M. Wise, Provost and Executive Vice President | ACTION | F-1 |
| 2. | Report of Contributions–February, 2009
Walter G. Dryfoos, Associate Vice President, Advancement Services
Connie Kravas, Vice President, University Advancement | INFORMATION | F-2 |
| 3. | Foster Business School Phase 2 (Balmer) – Review Schematic Design
Richard Chapman, Associate Vice President, Capital Projects Office
John Palewicz, Director, Capital Projects Central, Capital Projects Office | INFORMATION | F-3 |
| 4. | Capital Projects Office Semi-Annual Status Report
Richard Chapman | INFORMATION | F-4 |
| 5. | 2008 Internal Audit Results and Report of Planned Audit Activities for 2009
Charlene Hansen, Interim Director, Internal Audit | INFORMATION | F-5 |
| 6. | Executive Session
(To review the performance of a public employee.) | | |
| 7. | Executive Session
(To discuss with legal counsel representing the University, litigation or potential litigation to which the University is, or is likely to become, a party, when public knowledge regarding the discussion is likely to result in an adverse legal or financial consequence to the University.) | | |



AGENDA
BOARD OF REGENTS
University of Washington

SPECIAL MEETING

April 16, 2009
11:30 a.m.
UW Tower
22nd Floor, Board Room

(Item No.)

I. CALL TO ORDER

II. ROLL CALL – Assistant Secretary Kelly Keith

III. CONFIRM AGENDA

IV. REPORT OF THE CHAIR OF THE BOARD OF REGENTS: Regent Cole

Executive Session

(To discuss with legal counsel representing the University, litigation or potential litigation to which the University is, or is likely to become, a party, when public knowledge regarding the discussion is likely to result in an adverse legal or financial consequence to the University.)

Regents Resolution Regarding Executive Order 29

BP-1

Appointment of a Special Committee on the Future of the Metropolitan Tract

BP-2

V. REPORT OF THE UNIVERSITY PRESIDENT: Dr. Emmert

Budget Update (Information only)

UP-1

Faculty Presentation: The New Science of Learning: What's the Brain Have to Do With It? (Information only)

UP-2

VI. CONSENT AGENDA

Approval of Minutes of Special Meeting of March 18, 2009 and Meeting of March 19, 2009

Grant and Contract Awards – January and February, 2009

F-1

VII. STANDING COMMITTEES**A. Academic and Student Affairs Committee: Regent Simon – Chair**

Academic and Administrative Appointments (**ACTION**) A–1

Tri-Campus Update (Information only) A–2

An Invitation from the Faculty Senate to Visit Sites of Campus Research (Information only) A–3

B. Finance, Audit and Facilities Committee: Regent Blake – Chair

Report of Contributions–February, 2009 (Information only) F–2

Foster Business School Phase 2 (Balmer) – Review Schematic Design (Information only) F–3

Capital Projects Office Semi-Annual Status Report (Information only) F–4

2008 Internal Audit Results and Report of Planned Audit Activities for 2009 (Information only) F–5

VIII. OTHER BUSINESS

Reports from ex-officio representatives to the Board:

Faculty Senate Chair – Professor David Lovell

ASUW President – Mr. Anttimo Bennett

GPSS President – Mr. Jake Faleschini

Alumni Association President – Mr. Rick Osterhout

IX. DATE FOR NEXT REGULAR MEETING: Thursday, May 14, 2009**X. ADJOURNMENT**

MINUTES

SPECIAL MEETING OF THE BOARD OF REGENTS University of Washington

April 16, 2009

The Board of Regents held a special meeting on Thursday, April 16, 2009, beginning at 11:30 a.m. in the Board Room on the 22nd floor of the UW Tower. The notice of the meeting was appropriately provided to the public and the media.

CALL TO ORDER

ROLL CALL

Assistant Secretary Kelly Keith called the roll: Present were Regents Craig Cole (presiding), Kristianne Blake, Jeff Brotman, William Gates, Sally Jewell, Fred Kiga, Constance Proctor, Herb Simon, Jean-Paul Willynck; Dr. Mark Emmert, Ms. V'Ella Warren, Ms. Joan Goldblatt; ex-officio representatives: Professor David Lovell, Mr. Jake Faleschini, Mr. Rick Osterhout.

Absent: Regent Stanley Barer, Mr. Anttimo Bennett

CONFIRM AGENDA

The agenda was confirmed as presented.

REPORT OF THE CHAIR OF THE BOARD OF REGENTS: Regent Cole

EXECUTIVE SESSION

Regent Cole called for the Regents and others to meet in an Executive Session to discuss with legal counsel representing the University, litigation or potential litigation to which the University is, or is likely to become, a party, when public knowledge regarding the discussion is likely to result in an adverse legal or financial consequence to the University.

Following the executive session the Board reconvened in open session to take the following action.

Regents Resolution Regarding Executive Order 29 (Agenda no. BP-1)

MOTION: Upon the recommendation of the Chair of the Board, a motion was made by Regent Blake, and seconded by Regent Gates. Following discussion, comments, and questions, all the Regents voted in favor of adopting the resolution. Regent Willynck abstained.

See Attachment BP-1.

Appointment of Special Committee on the Future of the Metropolitan Tract
(Agenda no. BP-2)

It is the recommendation of the Chair that the Board of Regents approve the appointment of a special committee on the future of the Metropolitan Tract, and the adoption of the mission of the Committee.

MOTION: Upon the recommendation of the Chair of the Board and the motion made by Regent Blake, seconded by Regent Simon, the Board voted to approve the Appointment of a Special Committee on the Future of the Metropolitan Tract. All Regents voted in favor of the motion.

Regent Cole, as Board Chair, will appoint members to the Committee.

See Attachment BP-2.

REPORT OF THE UNIVERSITY PRESIDENT: Dr. Emmert

Faculty Presentation: The New Science of Learning: What's the Brain Have to Do With It? (Agenda no. UP-2) (Information only)

Provost Wise introduced Professor Patricia Kuhl from the UW's Institute for Learning and Brain Sciences, known as ILABS. Dr. Kuhl spoke about the research the Center is conducting in the science of learning. Dr. Kuhl invited Regents to visit the Center and view the new brain imaging equipment. Questions and discussion followed her presentation.

See Attachment UP-2.

Budget Update (Agenda no. UP-1) (Information only)

President Emmert updated the Regents on the status of the State budget. Provost Wise provided an update on the budget reduction process at the University. Paul Jenny, Vice Provost of Planning and Budgeting, distributed a current Planning and Budgeting Brief, and provided an overview of the status of the UW's operating and capital budgets from a legislative point of view. Draft budgets will be presented to the Board of Regents at the meeting in May. Questions and discussion followed the presentations.

See Attachment UP-1.

CONSENT AGENDA

Regent Cole noted there were two items for approval on the consent agenda, asked if any items should be removed, and called for a motion.

April 16, 2009

MOTION: Upon the recommendation of the Chair of the Board and the motion made by Regent Brotman, the Board voted to approve the two items on the consent agenda as shown below:

Approval of Minutes of Special Meeting of March 18, 2009 and Meeting of March 19, 2009

Grant and Contract Awards – January and February, 2009 (Agenda no. F-1)

It was the recommendation of the administration and the Finance, Audit and Facilities Committee the Board of Regents accept Grant and Contract Awards for the month of January, 2009 in the total amount of \$64,616,590, and for the month of February, 2009, in the total amount of \$57,926,360.

See Attachment F-1.

STANDING COMMITTEES

ACADEMIC AND STUDENT AFFAIRS COMMITTEE: Regent Simon, Chair

At the request of Regent Simon, Provost Wise said there were no appointments she wished to highlight.

Academic and Administrative Appointments (Agenda no. A-1)

MOTION: Upon the recommendation of the administration and the motion made by Regent Proctor, seconded by Regent Brotman, the Board voted to approve the personnel appointments. Regent Willynck abstained from the discussion and vote.

See Attachment A-1.

Tri-Campus Update (Agenda no. A-2)

Regent Simon reported Provost Phyllis Wise, Executive Vice Provost Doug Wadden, UW Bothell Chancellor Kenyon Chan, and UW Tacoma Chancellor Patricia Spakes provided an update on tri-campus issues and affairs. They are working on themes for accreditation, developing policy processes, and identifying emphases for their geographical areas. They continue to work through cross-campus enrollment issues.

Regent Simon praised the collaboration and good work being done by this group, and said the three campus university is maturing and growing. The group plans to return to the Board with an update in Autumn Quarter.

See Attachment A-2.

An Invitation from the Faculty Senate to Visit Sites of Campus Research (Agenda no. A-3)

April 16, 2009

Dr. Bruce Balick, Professor of Astronomy and Vice Chair of the Faculty Senate, invited Regents to visit sites of campus research. He proposed an ongoing program offering Regents the opportunity to meet with faculty and students engaged in research to view their accomplishments first hand.

Regent Simon said this would provide an exciting opportunity for Regents to learn more about the University.

See Attachment A-3.

FINANCE, AUDIT AND FACILITIES COMMITTEE: Regent Blake, Chair

Report of Contributions-February, 2009 (Agenda no. F-2) (Information only)

The total gifts received in February, 2009 was \$18,836,392, the total received year-to-date is \$210,441,178.

See Attachment F-2.

Foster Business School Phase 2 (Balmer)-Review Schematic Design (Agenda no. F-3)

Regents viewed the schematic design for Balmer Hall. Construction funding has become a major issue in this project. The proposed Foster Business School plan integrates the Paccar Building and Balmer Hall, so scaling back the project is not a viable option. Administration is exploring funding alternatives in order to move forward with the project as planned. Alternatively, the choice may be made to delay construction.

See Attachment F-3.

Capital Projects Office Semi-Annual Status Report (Agenda no. F-4)

Regent Blake reported Richard Chapman provided the Regents with an update from the Capital Projects Office. According to Chapman, construction costs are trending down, and Capital Projects is successfully re-negotiating ongoing contracts, yielding reductions of 15 to 20 %. Due to expected State budget cuts, however, there will be limited capital funding available to take advantage of this opportunity. Mr. Chapman described other buildings which are designed and ready to build, but lack funding for construction.

See Attachment F-4.

2008 Internal Audit Results and Report of Planned Audit Activities for 2009
(Agenda no. F-5)

Internal Audit staff described their activities for the past year and their planned activities for next year. Auditors told Regents they are mindful of the risks and potential impacts associated with an economic downturn. During these times, there may be less staff and controls in place. Internal Audit is committed to helping units deal with the unique challenges they face in times of economic downturn.

The planned executive session was deferred to a future meeting to allow President Emmert to attend.

See Attachment F-5.

REPORTS FROM EX OFFICIO REPRESENTATIVES TO THE BOARD OF REGENTS

Faculty Senate Chair: Professor David Lovell

Professor Lovell reported the Faculty Council on Faculty Affairs passed two pieces of class "A" legislation, subject to full senate confirmation.

The first piece of legislation updated the procedures associated with the Reorganization, Consolidation, and Elimination of Programs (RCEP) process to make it more transparent, and to clarify the roles of participants in the process. Despite the changes, Lovell said it remains a slow process.

Two RCEPs have been initiated recently. The first is to move the College of Forest Resources into the College of the Environment, the second RECP will move two departments from Arts and Sciences (Atmospheric Sciences and Earth and Space Sciences), one department from the College of Ocean and Fishery Sciences (School of Marine Affairs), and the Program On the Environment, into the College of the Environment.

The second piece of legislation expands the number of conciliation officers from six to up to twenty-four. Conciliation provides a less costly alternative to adjudication.

Regarding budget cuts, the Senate Committee on Planning and Budgeting (SCPB) is grateful for the clear information received from the UW's Office of Planning and Budgeting. As incoming Chair of the SCPB, Dr. Lovell said he looks forward to continuing, and building upon, the current good working relationship with the administration.

ASUW President: Mr. Anttimo Bennett

Mr. Bennett did not attend the meeting.

GPSS President: Mr. Jake Faleschini

Mr. Faleschini introduced ASUW Bothell President, Emily Anderson, and ASUW Tacoma President, Tommy Bauer, who both made brief remarks.

Mr. Faleschini reported ASUW and GPSS elections will be held at the end of April.

He reported ASUW recently passed a resolution reconfirming their desire to continue with the construction and renovation of the HUB, ECC, and Hall Health. GPSS will

April 16, 2009

consider this issue at the end of April. Construction on these projects is scheduled to begin in 2011.

Mr. Faleschini said the University is launching a “Student Health Insurance – Plus” plan, developed with the Office of Student Life. It will offer students an enhanced health insurance option. This will begin in Autumn Quarter of 2009.

GPSS is partnering with the guide book publisher of “Not for Tourists” to replace the UW’s “Guide to Life” with a chapter in the book “Not for Tourists – University of Washington Student Edition.” This resource is used by incoming UW graduate students.

Questions and discussion followed Mr. Faleschini’s remarks. Regent Cole stated the University is committed to allocating a portion of the additional tuition to some form of financial aid.

Alumni Association President: Mr. Rick Osterhout

Mr. Osterhout reported on two upcoming alumni events - the Coaches Tour and the Spring Football Game.

He distributed the Office of Minority Affairs and Diversity’s Viewpoints publication and called attention to the “40 Under 40 Emerging Leaders” article.

Mr. Osterhout highlighted two upcoming lectures. The first is the 2009 Nobel Prize Lecture featuring UW Assistant Professor Yu-chin Chen, who will speak on “The Brilliance Behind the Columns: Paul Krugman, an Economist of Scale.” In her talk, Professor Chen will examine the work of Professor Paul Krugman, the recipient of the 2008 Nobel Prize in Economics. The second is an eight-part lecture series entitled “Coffee From the Grounds Up.”

Osterhout described the private efforts of UW alumni to work effectively with the legislature on behalf of the University. He is exploring how most effectively to deploy the UW’s 55,000 alumni to develop relationships with legislators throughout the year to convey the importance of higher education to the State.

DATE FOR NEXT MEETING

The next regular meeting of the Board of Regents will be held on Thursday, May 14, 2009, at the UW Tower.

ADJOURNMENT

The special meeting was adjourned at 2:45 p.m.



Joan Goldblatt
Secretary of the Board of Regents

BOARD OF REGENTS SPECIAL MEETING

April 16, 2009

8

TO: Board of Regents

FROM: Craig Cole, Chair

DATE: April 20, 2009

SUBJECT: Appointment of Special Committee on the Future of the Metropolitan Tract

Pursuant to the authorization by the Board of Regents on April 16, 2009, the following are appointed to serve on the Special Committee on the Future of the Metropolitan Tract. Service is at the pleasure of the Board Chair:

Regent Jeff Brotman
Regent Sally Jewell
Regent Herb Simon

The Board Chair serves on the committee in an ex-officio capacity, in the same manner as with other committees of the Board of Regents.

From those Regents who expressed an interest in serving (all of whom are certainly qualified), I have selected those members whose terms do not expire in September, 2009. I hope this is acceptable to everyone.

Please call if you have any questions.

Mission of the Special Committee on the Future of the Metropolitan Tract

To provide advice and consultation to the President and/or the President's designees, and to the Board of Regents, on strategic alternatives relating to the future of the Metropolitan Tract, while leaving oversight of the normal management and financial affairs of the Tract to the Finance, Audit, and Facilities Committee.

May 4, 2009

From Craig Cole:

Upon the advice of the members of the committee, and with Jeff's kind agreement, Regent Brotman is hereby designated as the committee's chair.

cc: Mark Emmert, President
V'Ella Warren, Treasurer
Jack Johnson, Attorney General

VII. STANDING COMMITTEES

A. Academic and Student Affairs Committee

Academic and Administrative Appointments

RECOMMENDED ACTION:

It is the recommendation of the administration and the Academic and Student Affairs Committee the Board of Regents approve the appointments to the University faculty and administration as presented on the attached list.

Attachment: Personnel Recommendations

COLLEGE OF ARTS AND SCIENCES

DANCE PROGRAM

NEW APPOINTMENTS

KOCH FABER, JURG PETER

(MA, 1998, UNIVERSITY OF KENT) TO BE ASSISTANT PROFESSOR OF DANCE AT A SALARY RATE OF \$57,285 OVER NINE MONTHS, EFFECTIVE 9/16/2008. (PRIOR TO THIS APPOINTMENT, MR. KOCH FABER WAS A LECTURER, FULL TIME IN THE SAME DEPARTMENT.)

DEPARTMENT OF APPLIED MATHEMATICS

NEW APPOINTMENTS

TODOROV, EMANUEL

(BS, 1993, WEST VIRGINIA WESLEYAN COLLEGE; PHD, 1998, MASSACHUSETTS INSTITUTE OF TECHNOLOGY) TO BE ASSOCIATE PROFESSOR OF APPLIED MATHEMATICS AND ASSOCIATE PROFESSOR OF COMPUTER SCIENCE AND ENGINEERING AT A SALARY RATE OF \$100,080 OVER NINE MONTHS, EFFECTIVE 3/1/2009. (PRIOR TO THIS APPOINTMENT, DR. TODOROV WAS ASSOCIATE PROFESSOR OF COGNITIVE SCIENCE AT THE UNIVERSITY OF CALIFORNIA, SAN DIEGO.)

DEPARTMENT OF PHILOSOPHY

NEW APPOINTMENTS

MANCHAK, JOHN BYRON

(BS, 2004, BRIGHAM YOUNG UNIVERSITY; PHD, 2009, UNIVERSITY OF CALIFORNIA (IRVINE)) TO BE ASSISTANT PROFESSOR OF PHILOSOPHY AT A SALARY RATE OF \$65,007 OVER NINE MONTHS, EFFECTIVE 9/16/2009.

DEPARTMENT OF PHYSICS

NEW APPOINTMENTS

LIN, HUEY-WEN

(BS, 1999, NATIONAL TAIWAN UNIVERSITY; MA, 2002, COLUMBIA UNIVERSITY; PHD, 2007, COLUMBIA UNIVERSITY) TO BE RESEARCH ASSISTANT PROFESSOR OF PHYSICS AT A SALARY RATE OF \$60,000 OVER TWELVE MONTHS, EFFECTIVE 7/1/2009. (DR. LIN IS CURRENTLY A POST-DOCTORAL FELLOW AT THE JEFFERSON LABORATORY.)

DIVISION OF FRENCH AND ITALIAN STUDIES

NEW APPOINTMENTS

WATTS, RICHARD HENRY

(BA, 1989, UNIVERSITY OF CALIFORNIA (SANTA BARBARA); MA, 1993, YALE UNIVERSITY; MPhil, 1994, YALE UNIVERSITY; PHD, 1998, YALE UNIVERSITY) TO BE ASSOCIATE PROFESSOR OF FRENCH AND ITALIAN STUDIES AT A SALARY RATE OF \$75,006 OVER NINE MONTHS, EFFECTIVE 9/16/2009. (DR. WATTS IS CURRENTLY ASSOCIATE PROFESSOR OF FRENCH AND ASSOCIATE DEAN FOR INTERNATIONAL PROGRAMS AT TULANE UNIVERSITY.)

SCHOOL OF DRAMA

NEW APPOINTMENTS

FRACE, JEFFREY

(BA, 1990, OBERLIN COLLEGE; MFA, 1997, COLUMBIA UNIVERSITY) TO BE ASSISTANT PROFESSOR OF DRAMA AT A SALARY RATE OF \$61,506 OVER NINE MONTHS, EFFECTIVE 9/16/2009.

COLLEGE OF ENGINEERING

DEPARTMENT OF CIVIL AND ENVIRONMENTAL ENGINEERING

NEW APPOINTMENTS

THOMSON, JAMES

(BA, 2000, MIDDLEBURY COLLEGE; PHD, 2006, MASSACHUSETTS INSTITUTE OF TECHNOLOGY) TO BE ASSISTANT PROFESSOR WITHOUT TENURE OF CIVIL AND ENVIRONMENTAL ENGINEERING WITHOUT SALARY FROM THE UNIVERSITY, EFFECTIVE 3/16/2009. (DR. THOMSON WILL CONTINUE AS AN OCEANOGRAPHER IN THE APPLIED PHYSICS LABORATORY.)

DEPARTMENT OF ELECTRICAL ENGINEERING

NEW APPOINTMENTS

ARABSHAHI, PAYMAN

(BS, 1988, UNIVERSITY OF ALABAMA; MS, 1990, UNIVERSITY OF WASHINGTON; PHD, 1994, UNIVERSITY OF WASHINGTON) TO BE ASSOCIATE PROFESSOR WITHOUT TENURE OF ELECTRICAL ENGINEERING WITHOUT SALARY FROM THE UNIVERSITY, EFFECTIVE 3/16/2009. (DR. ARABSHAHI WILL CONTINUE AS A SENIOR ENGINEER IN THE APPLIED PHYSICS LABORATORY.)

DEPARTMENT OF INDUSTRIAL ENGINEERING

NEW APPOINTMENTS

BOYLE, LINDA

(BS, 1986, STATE UNIVERSITY OF NEW YORK (BUFFALO); MSEng, 1994, UNIVERSITY OF WASHINGTON; PHD, 1998, UNIVERSITY OF WASHINGTON) TO BE ASSOCIATE PROFESSOR OF INDUSTRIAL ENGINEERING AND ASSOCIATE PROFESSOR OF CIVIL AND ENVIRONMENTAL ENGINEERING AT A SALARY RATE OF \$94,995 OVER NINE MONTHS, EFFECTIVE 8/16/2009. (DR. BOYLE IS CURRENTLY AN ASSOCIATE PROFESSOR OF MECHANICAL AND INDUSTRIAL ENGINEERING AT THE UNIVERSITY OF IOWA.)

DEPARTMENT OF MECHANICAL ENGINEERING

NEW APPOINTMENTS

POLAGYE, BRIAN

(BS, 2000, PRINCETON UNIVERSITY; MSME, 2005, UNIVERSITY OF WASHINGTON; PHD, 2009, UNIVERSITY OF WASHINGTON) TO BE RESEARCH ASSISTANT PROFESSOR OF MECHANICAL ENGINEERING AT A SALARY RATE OF \$82,800 OVER TWELVE MONTHS, EFFECTIVE 4/1/2009.

DANIEL J. EVANS SCHOOL OF PUBLIC AFFAIRS

EVANS SCHOOL OF PUBLIC AFFAIRS

NEW APPOINTMENTS

HEINEKE, JANELLE

(BSN, 1975, MARQUETTE UNIVERSITY; MSN, 1979, BOSTON COLLEGE; MBA, 1987, BOSTON COLLEGE; DBA, 1992, BOSTON UNIVERSITY) TO BE VISITING PROFESSOR, PART-TIME, OF PUBLIC AFFAIRS AT A SALARY RATE OF \$6,435 OVER THREE MONTHS, EFFECTIVE 12/16/2008. (DR. HEINEKE IS A PROFESSOR AT BOSTON UNIVERSITY SCHOOL OF MANAGEMENT.)

SCHOOL OF DENTISTRY

DEPARTMENT OF ORAL MEDICINE

NEW APPOINTMENTS

STOLZEMBACH, ANA MARTINEZ

(DDS, 1998, UNIVERSIDAD PERUANA CAYETANO HEREDIA) TO BE CLINICAL ASSISTANT PROFESSOR-DENTAL PATHWAY OF ORAL MEDICINE AT A SALARY RATE OF \$97,596 OVER TWELVE MONTHS, EFFECTIVE 3/1/2009. (PRIOR TO THIS APPOINTMENT DR. MARTINEZ STOLZEMBACH WAS A VISITING ASSISTANT PROFESSOR IN THE SAME DEPARTMENT.)

DEPARTMENT OF RESTORATIVE DENTISTRY

NEW APPOINTMENTS

SHOR, KAVITA CHIGURUPATI

(BDentS, 1990, GOA UNIVERSITY (INDIA); MSD, 2001, UNIVERSITY OF WASHINGTON) TO BE ASSISTANT PROFESSOR OF RESTORATIVE DENTISTRY AT A SALARY RATE OF \$99,996 OVER TWELVE MONTHS, EFFECTIVE 4/1/2009. (PRIOR TO THIS APPOINTMENT DR. SHOR WAS AN AFFILIATE ASSISTANT PROFESSOR IN THE DEPARTMENT OF PEDIATRIC DENTISTRY.)

SCHOOL OF MEDICINE

DEPARTMENT OF ANESTHESIOLOGY AND PAIN MEDICINE

NEW APPOINTMENTS

TIAN, RONG

(MD, 1986, WEST CHINA UNIVERSITY; PHD, 1992, UNIVERSITY OF AARHUS (DENMARK)) TO BE PROFESSOR OF ANESTHESIOLOGY AND PAIN MEDICINE AT A SALARY RATE OF \$200,016 OVER TWELVE MONTHS, EFFECTIVE 4/1/2009. (PRIOR TO THIS APPOINTMENT, DR. TIAN WAS ASSOCIATE PROFESSOR OF MEDICINE AT HARVARD MEDICAL SCHOOL.)

DEPARTMENT OF MEDICINE

NEW APPOINTMENTS

GRIES, CYNTHIA JANE

(BA, 1994, CORNELL UNIVERSITY; MD, 2001, UNIVERSITY OF CHICAGO; MSc, 2007, UNIVERSITY OF WASHINGTON) TO BE ASSISTANT PROFESSOR WITHOUT TENURE OF MEDICINE AT A SALARY RATE OF \$130,008 OVER TWELVE MONTHS, EFFECTIVE 3/1/2009. (PRIOR TO THIS APPOINTMENT, DR. GRIES WAS AN ACTING INSTRUCTOR IN THE SAME DEPARTMENT.)

WEST, TIMOTHY E.

(BS, 1995, YALE UNIVERSITY; MD, 1999, MEDICAL COLLEGE OF VIRGINIA; MPH, 2005, HARVARD UNIVERSITY) TO BE ASSISTANT PROFESSOR WITHOUT TENURE OF MEDICINE AT A SALARY RATE OF \$130,008 OVER TWELVE MONTHS, EFFECTIVE 3/1/2009. (PRIOR TO THIS APPOINTMENT, DR. WEST WAS AN ACTING INSTRUCTOR AND SENIOR FELLOW IN THE SAME DEPARTMENT.)

DEPARTMENT OF NEUROLOGICAL SURGERY

NEW APPOINTMENTS

HEBB, ADAM O.

(BSC, 1996, DALHOUSIE UNIVERSITY (CANADA); MD, 2000, DALHOUSIE UNIVERSITY (CANADA)) TO BE ASSISTANT PROFESSOR WITHOUT TENURE OF NEUROLOGICAL SURGERY AT A SALARY RATE OF \$104,004 OVER TWELVE MONTHS, EFFECTIVE 2/1/2009. (PRIOR TO THIS APPOINTMENT, DR. HEBB WAS AN ACTING ASSISTANT PROFESSOR, TEMPORARY IN THE SAME DEPARTMENT.)

SCHOOL OF PUBLIC HEALTH

DEPARTMENT OF EPIDEMIOLOGY

NEW APPOINTMENTS

ENQUOBAHRIE, DANIEL ASMAMAW

(MD, 1996, ADDIS ABABA UNIVERSITY (ETHIOPIA); MPH, 2005, UNIVERSITY OF WASHINGTON; PHD, 2007, UNIVERSITY OF WASHINGTON) TO BE ASSISTANT PROFESSOR WITHOUT TENURE OF EPIDEMIOLOGY AT A SALARY RATE OF \$90,000 OVER TWELVE MONTHS, EFFECTIVE 6/1/2009. (DR. ENQUOBAHRIE IS CURRENTLY A RESEARCH FELLOW AT THE HARVARD SCHOOL OF PUBLIC HEALTH.)

UNIVERSITY OF WASHINGTON, BOTHELL

BUSINESS PROGRAM

ADMINISTRATIVE APPOINTMENTS

KRISHNAMURTHY, SANDEEP

(B OF TECH, 1988, INDIAN INSTITUTE OF TECHNOLOGY (INDIA); MBA, 1992, XAVIER LABOUR RELATIONS INSTITUTE (INDIA); PHD, 1996, UNIVERSITY OF ARIZONA) TO BE DIRECTOR OF THE BUSINESS PROGRAM, EFFECTIVE 8/1/2009. (DR. KRISHNAMURTHY WILL CONTINUE AS ASSOCIATE PROFESSOR OF BUSINESS.)

NEW APPOINTMENTS

LI, YING

(BA, 1996, ZHONGSHAN UNIVERSITY (CHINA); MA, 1999, ZHONGSHAN UNIVERSITY (CHINA); PHD, 2006, UNIVERSITY OF MASSACHUSETTS) TO BE ASSISTANT PROFESSOR OF BUSINESS AT A SALARY RATE OF \$139,995 OVER NINE MONTHS, EFFECTIVE 8/1/2009. (DR. LI IS CURRENTLY AN ASSISTANT PROFESSOR OF FINANCE AT INDIANA UNIVERSITY, SOUTH BEND.)

INTERDISCIPLINARY ARTS AND SCIENCES PROGRAM

NEW APPOINTMENTS

HIEBERT, THEODOR

(BFA, 1997, UNIVERSITY OF VICTORIA (CANADA); MFA, 1999, UNIVERSITY OF CALGARY (CANADA); PHD, 2007, CONCORDIA UNIVERSITY (CANADA)) TO BE ASSISTANT PROFESSOR OF INTERDISCIPLINARY ARTS AND SCIENCES AT A SALARY RATE OF \$66,006 OVER NINE MONTHS, EFFECTIVE 8/16/2009. (DR. HIEBERT IS CURRENTLY A RESEARCH FELLOW AT THE PACIFIC CENTRE FOR TECHNOLOGY AND CULTURE, UNIVERSITY OF VICTORIA.)

VII. STANDING COMMITTEES

A. Academic and Student Affairs Committee

Tri-Campus Update

This will be an oral presentation.
For information only

VII. STANDING COMMITTEES

A. Academic and Student Affairs Committee

An Invitation from the Faculty Senate to Visit Sites of Campus Research

Professor Bruce Balick, Professor of Astronomy and Vice Chair of the Faculty Senate

For information only

Attachment.

An Invitation from the Faculty Senate to Visits Sites of Campus Research

Goals: to engage the Regents in the excitement of learning activities at UW through:

- Discussions of frontier research projects and results with articulate faculty,
- Firsthand observations and conversations that show how UW students participate in exciting faculty-led research and scholarship,
- Tours of a few of UW's major state-of-the-art research facilities,
- Optional visits to undergraduate classes

Proposal: Visits once per quarter on afternoons prior to scheduled Board of Regents meetings;
select from a menu of eight possible events per year; invitations to two regents at a time.



*"They're harmless when they're alone, but
get a bunch of them together with a
research grant and watch out."*

New Yorker, c.2004

Below is a list of examples of widely engaging research (in no particular order) plucked from various websites on the Seattle campus. There are many more.

1. History (Jim Gregory, Professor of History). Hear about the Civil Rights and Labor Histories of Seattle. This online project explores the history of movements for racial and economic justice in Seattle and western Washington State. This online resource features more than 70 interviews with former activists as well as hundreds of photographs, documents, and research reports starting well before the civil rights movements of the 50s and 60s.

2. Jackson School (Joel Migdal, Provost's Distinguished Lecturer 2008). Learn about microfinancing programs in third-world countries and the many participating NGOs from Seattle.

An Invitation from the Faculty Senate to Visits Sites of Campus Research

3. Asian Languages (Richard Salomon, Director, Early Buddhist Manuscripts Project, with Collett Cox). Learn of the project at UW to decipher the most ancient Buddhist manuscript and attend a seminar on the research.
4. Biochemistry/eScience (David Baker, co-winner of The Raymond & Beverly Sackler International Prize in Biophysics, 2008). Hear about models of protein-folding is essential for determining how genetic information directs protein formation, how proteins work, and how misfolded, misshapen, and malfunctioning proteins might underlie serious degenerative diseases.
5. DX Arts (Shawn Brixley, Director and Richard Karpen, Founding Director). Experience the innovative forms of art being developed and to watch students at work in a studio.
6. Chemical Engineering (Guozhong Cao, Professor of Materials Science and Engineering). Visit the lab of the project to increase efficiency of solar cells. Recent results have more than doubled the efficiency of photovoltaic devices.
7. Green Futures Research & Design Lab (Nancy Rottle, College of Built Environments). Explore how this program and other units in the college develop innovative approaches to the ecological planning and design of public space through interdisciplinary research, design and education.
8. The Decision to drop the Bomb, 1945 (Bruce Hevley, History of Science). Discuss how the decision was reached to deploy the A Bomb on Japan, including the complex political issues. Chapters 16 and 17 of "The Making of the Atomic Bomb" book by Richard Rhodes will provide much of the background for a very lively discussion.
9. Global Health (Christopher J.L. Murray, Director). Learn more about one of the newest and most exciting Global Health Programs at UW: The Institute for Health Metrics & Evaluation. IHME aspires to make available to the world high quality information on population health, its determinants, and the performance of health systems.
10. Medicine/Autism Center (Stephen Dager, Interim Director). Learn how the UW Autism program has established a program of diagnostic evaluations and multi-disciplinary intervention services for children with autism spectrum disorders from infancy through adolescence and a wide range of professional training opportunities.
11. Sustainable Business Practices. (Martin Westerman, Business). Westerman teaches a senior course that covers how firms can restructure their thinking, operations, products and services so they can become more ecologically efficient, and create less negative impacts on the planet, which support them.
12. Law (Michael Robinson-Dorn, Berman Environmental Law Clinic & Assistant Professor of Law). Find out how the law clinic provides legal support for environmental activities around the state. The clinic's caseload covers all aspects of environmental law from issues of air and water pollution, nuclear power plant sites, wildlife and marine protection, fisheries, toxics, to the Federal Advisory Committee Act.

Goal: To showcase research @ U.W.

What

- Projects within departments
- Selection criteria:
 - Interesting, exciting, and explainable topic
 - Engages under/grad students
 - Strategic impact on Dept/College

When

- Once per quarter, 1.5 - 3 hours
- Afternoon prior to normal BOR meetings

Who/Where

- Intimate: ≈2 two regents + faculty/students
- "Al fresco" (*in the lab, that is*)



Visit Plan: Optional + Standard Events

- 1:00: greeting in Gerberding 36
- 1:10: escorted walk to the department
- 1:15: welcome by Dept Chair
- 1:25: attend regular class lecture
- (2:20: greeting in Gerber 36, escorted walk)
- 2:30: talk with department chair, short briefing on Dept's history, current activities, & aspirations
- 3:00: visit with selected faculty member and associated students in their 'native habitat'
- 3:50: visit ends; departure



Preview of First Visit

Astronomy's Strategic Research Plan: "Deep-Sky Survey Science"

Since 1999: "Sloan Digital Sky Survey"

*What is SDSS? 94-inch aperture and 120-megapixel, 5-color camera
1/3 billion stars, galaxies & quasars, 1300 new asteroids, 300 supernovae
Plus supplemental spectra of 460,000 stars, 930,000 galaxies, 120,000 quasars*

- Construction: UW-Princeton-JHU-Fermilab partnership
- Operational since 2000 @ Apache Point NM
- Now 25 international partners
- Funding: Sloan, NSF, DOE, partners
- 2000 publications; 70,000 citations
- @UW: 100 under/grads, many publications
- Heart of 'Google Sky'

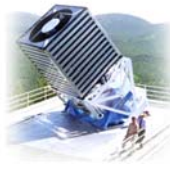

Future: "Large Synoptic Survey Telescope" (LSST)



Mirror courtesy Charles Simonyi & Bill Gates Jr.

*What is LSST? 330-inch aperture w/ 3200 megapixels, 4 colors
100x more stars, galaxies, asteroids, cosmological supernovae*

- New science includes dark energy, NEOs, planet searches
- LSST is now a 'decadal priority' of U.S. astronomy
 - \$470M/NSF+DOE, \$30M private, \$100K/UW (seed)
 - Operational 2014 @ high Andes, Chile
 - UW one of four founding partners
- Major element in UW's 'e-Science' initiative

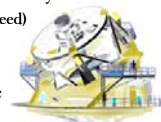

Program Launch

*What: "Astronomical Surveys:
Revelations of the Deep Cosmos"*

*Who: Profs. Zeljko Ivezic & Andy Connolly
(Introduced by Chair Suzanne Hawley)*

When: June 10, 2009, 3:00 (90 minutes)

*Where: Meet at Faculty Senate Office,
Gerberding 36, 2:45 P.M.*

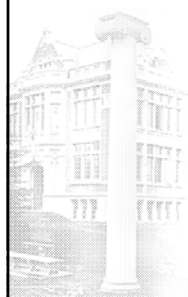

VII. STANDING COMMITTEES**B. Finance, Audit and Facilities Committee****Grant and Contract Awards – January and February, 2009****RECOMMENDED ACTION:**

It is the recommendation of the administration and the Finance and Audit Committee that the Board of Regents accept the Grant and Contract Awards as presented on the attached list.

Attachment: Grant and Contract Awards Summary
 Report of Grant and Contract Awards of
 \$1,000,000 or More

Grant and Contract Awards Summary

to

The Board of Regents

of the

University of Washington

for

January 2009

Office of Research

Office of Sponsored Programs

Table of Contents

Graphical Summary of Award Activity	3
Summary of Grant and Contract Awards	4
Comparison of Grants and Contract Awards by Agency	5
Comparison of Grants and Contract Awards by School/College	6
Listing of Awards for College of Arts and Sciences by Department	7
Summary of Grant Awards – Excluding Private Awards	8
Summary of Grant Awards - Private Awards	9
Summary of Contract Awards	10
Report of Grant & Contract Awards over \$1,000,000	11

January Only
Comparison of Grant & Contract Awards

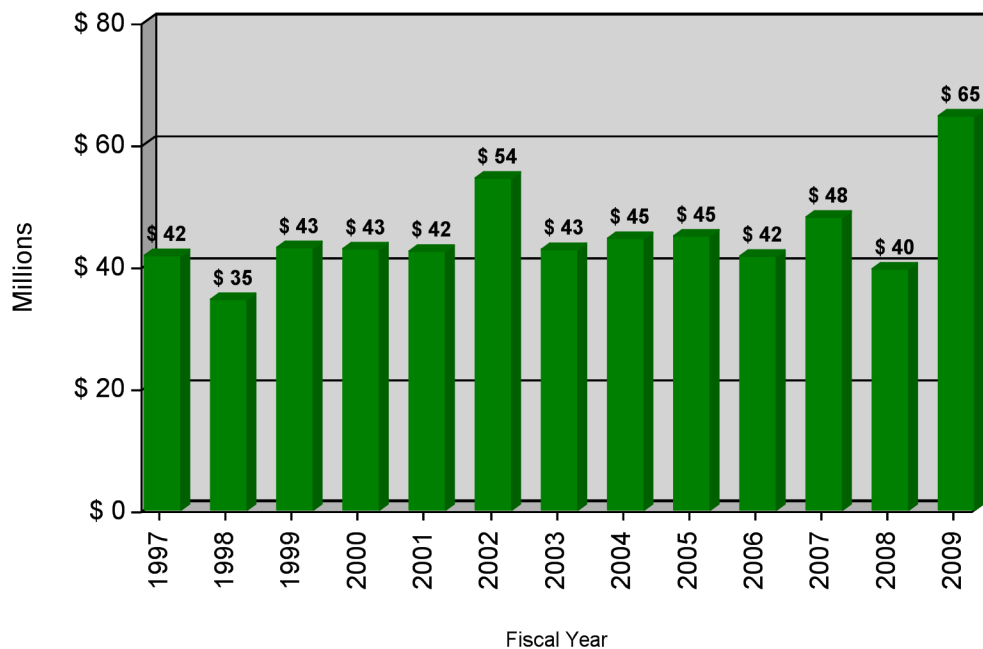

Fiscal Year to Date
Comparison of Grant & Contract Awards

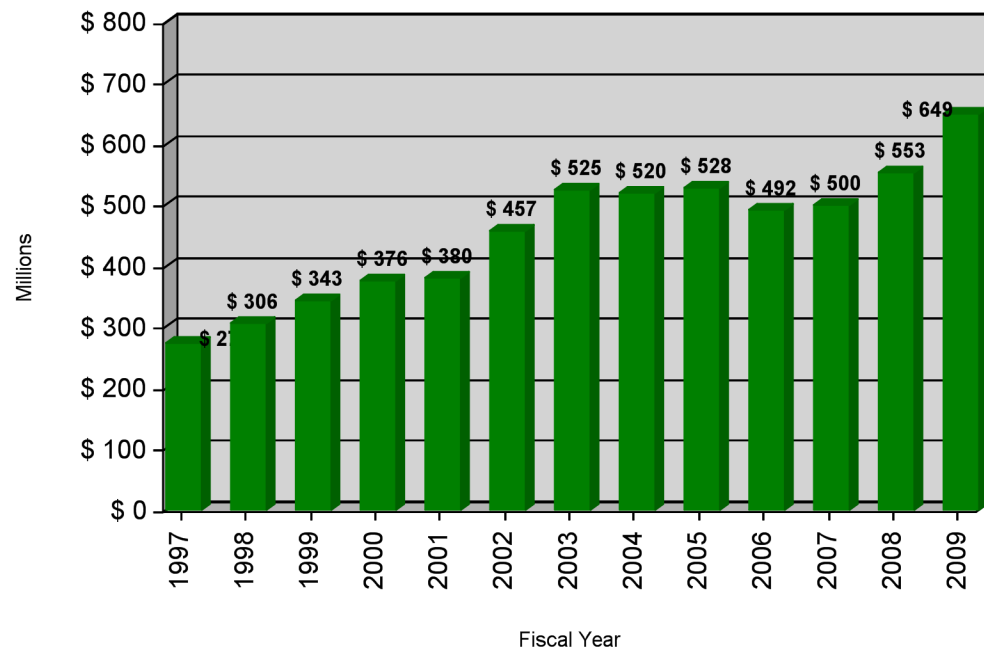

Complete Fiscal Year
Comparison of Grant & Contract Awards

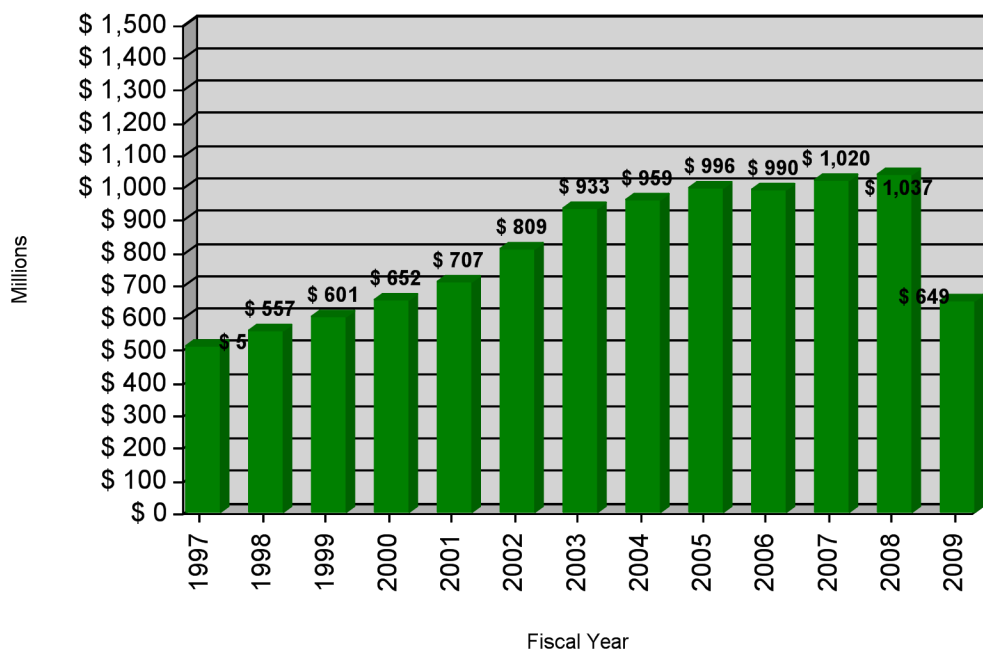

Fiscal Year to Date
Two-Year Comparison of Grant and Contract Awards

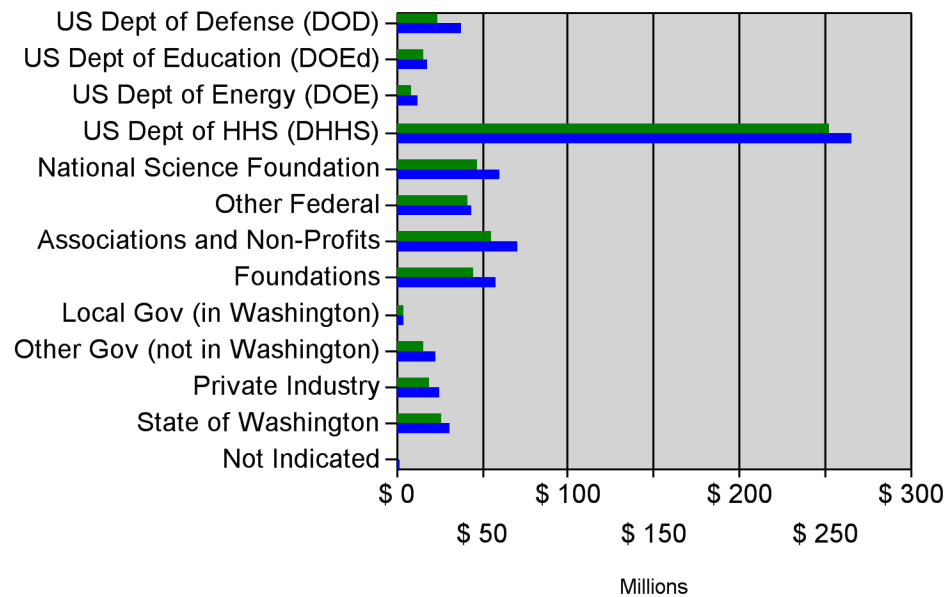

Jul-Jan FY08 Jul-Jan FY09

Summary of Grant and Contract Awards

Fiscal Year 2008-2009

Month	RESEARCH AND OTHER		TRAINING		Total Grants and Contracts
	Federal	Non-Federal	Federal	Non-Federal	
July	\$ 86,111,310	\$ 16,220,680	\$ 9,776,757	\$ 3,001,990	\$ 115,110,700
August	\$ 59,011,790	\$ 22,463,880	\$ 7,944,685	\$ 1,036,159	\$ 90,456,520
September	\$ 105,344,800	\$ 20,093,510	\$ 9,282,558	\$ 1,091,509	\$ 135,812,400
October	\$ 63,252,340	\$ 52,224,910	\$ 6,130,011	\$ 2,279,804	\$ 123,887,100
November	\$ 22,820,940	\$ 33,744,240	\$ 1,145,695	\$ 2,762,181	\$ 60,473,060
December	\$ 34,707,560	\$ 22,962,860	\$ 102,730	\$ 979,880	\$ 58,753,020
January	\$ 30,515,450	\$ 31,376,650	\$ 1,467,602	\$ 1,256,889	\$ 64,616,590
<hr/>					
FY09 to Date	\$401,829,421	\$199,021,505	\$35,850,038	\$12,408,412	\$649,109,377
<hr/>					
FY08 to Date	\$352,251,433	\$148,719,423	\$35,768,088	\$16,202,074	\$552,941,018
<hr/>					
Over (Under) Previous Year	\$49,577,988	\$50,302,083	\$81,950	(\$3,793,662)	\$96,168,359

Assuming acceptance of all awards by the Board of Regents

Comparison of Grant and Contract Awards by Agency

Fiscal Years 2007-2008 and 2008-2009

Agency	Jul-Jan FY08	Jul-Jan FY09
US Department of Defense (DOD)	\$ 23,655,865	\$ 38,285,461
US Department of Education (DOEd)	\$ 16,107,449	\$ 18,492,986
US Department of Energy (DOE)	\$ 8,270,169	\$ 11,839,583
US Department of Health and Human Services (DHHS)	\$ 251,714,465	\$ 265,177,288
National Science Foundation (NSF)	\$ 46,919,255	\$ 60,356,511
Other Federal	\$ 41,352,318	\$ 43,527,630
Subtotal for Federal :	\$ 388,019,521	\$ 437,679,459
Associations and Non-Profits	\$ 54,722,557	\$ 70,165,974
Foundations	\$ 44,939,506	\$ 57,044,286
Local Government (in Washington)	\$ 3,867,616	\$ 4,360,168
Other Government (not in Washington)	\$ 15,967,270	\$ 23,167,756
Private Industry	\$ 19,539,920	\$ 25,502,192
State of Washington	\$ 25,884,627	\$ 31,166,982
Not Indicated	\$ 0	\$ 22,559
Subtotal for Non-Federal :	\$ 164,921,497	\$ 211,429,918
Grand Total :	\$ 552,941,018	\$ 649,109,377
Amount of Increase (Decrease) :		\$ 96,168,359
Percent of Increase (Decrease) :		17.4 %

Assuming acceptance of all awards by the Board of Regents

Comparison of Grant and Contract Awards by School/College

Fiscal Years 2007-2008 and 2008-2009

School/College		Jul-Jan FY08	Jul-Jan FY09
Upper Campus			
	Architecture and Urban Planning	\$ 637,289	\$ 1,521,544
	Arts and Sciences	\$ 49,088,661	\$ 59,057,728
	Business Administration	\$ 740,458	\$ 770,000
	Director of Libraries	\$ 116,500	\$ 6,856,985
	Education	\$ 1,809,345	\$ 6,525,234
	Educational Outreach	\$ 287,668	\$ 96,400
	Engineering	\$ 41,913,488	\$ 51,434,991
	Evans School of Public Affairs	\$ 1,999,160	\$ 1,972,762
	Executive Vice President	\$ 208,000	\$ 621,238
	Forest Resources	\$ 3,730,088	\$ 5,789,514
	Graduate School	\$ 1,008,619	\$ 4,245,870
	Information School	\$ 4,281,229	\$ 4,873,483
	Law	\$ 245,734	\$ 1,653,453
	Ocean and Fishery Sciences	\$ 52,919,563	\$ 56,912,590
	Office of Research	\$ 17,682,317	\$ 16,368,710
	Provost	\$ 200,000	\$ 57,424
	Social Work	\$ 8,641,657	\$ 9,616,952
	Undergraduate Education	\$ 326,802	\$ 234,944
	VP Educational Partnerships	\$ 43,745	\$ 30,000
	VP Minority Affairs	\$ 7,034,709	\$ 6,612,603
	Subtotal :	\$ 192,915,031	\$ 235,252,424
Health Sciences			
	Dentistry	\$ 4,970,032	\$ 5,771,748
	Medicine	\$ 266,717,335	\$ 320,873,350
	Nursing	\$ 9,698,513	\$ 8,253,614
	Pharmacy	\$ 4,909,262	\$ 6,336,993
	Public Health and Community Medicine	\$ 45,738,724	\$ 43,242,948
	Subtotal :	\$ 332,033,865	\$ 384,478,653
Special Programs			
	Alcohol and Drug Abuse Institute	\$ 3,192,422	\$ 2,060,091
	CHDD Administration	\$ 7,219,838	\$ 5,061,478
	Regional Primate Center	\$ 16,158,609	\$ 18,523,047
	Subtotal :	\$ 26,570,869	\$ 25,644,616
Other UW Campuses			
	Bothell	\$ 1,193,411	\$ 3,198,925
	Tacoma	\$ 218,450	\$ 509,838
	Subtotal :	\$ 1,411,861	\$ 3,708,763
Not Indicated	Not Indicated	\$ 9,391	\$ 24,000

School/College		Jul-Jan FY08	Jul-Jan FY09
Not Indicated	Tacoma		\$ 920
	Subtotal :	\$ 9,391	\$ 24,920
	Grand Total :	\$ 552,941,018	\$ 649,109,377

Assuming acceptance of all awards by the Board of Regents

List of Awards for Arts and Sciences

Fiscal Years 2007-2008 and 2008-2009

Department	Jul-Jan FY08	Jul-Jan FY09
Center for Humanities	\$0	\$ 625,000
Center for Statistics and the Social Sciences	\$ 736,119	\$ 96,213
Center for Studies in Demography and Ecology	\$ 1,889,361	\$ 1,824,263
Dance Program	\$0	\$ 10,000
Department of Anthropology	\$ 249,016	\$ 353,001
Department of Applied Mathematics	\$ 22,943	\$ 657,408
Department of Asian Languages and Literature	\$0	\$ 100,000
Department of Astronomy	\$ 3,182,242	\$ 5,978,960
Department of Atmospheric Sciences	\$ 2,547,033	\$ 3,459,059
Department of Biology	\$ 3,252,436	\$ 5,113,618
Department of Chemistry	\$ 14,581,090	\$ 15,730,420
Department of Classics	\$0	\$ 2,000
Department of Communication	\$ 1,395,680	\$ 697,385
Department of Earth and Space Sciences	\$ 2,550,268	\$ 5,100,083
Department of Economics	\$ 6,575	\$ 63,560
Department of English	\$ 77,573	\$ 56,000
Department of Geography	\$ 336,787	\$ 12,000
Department of Germanics	\$ 53,000	\$0
Department of History	\$0	\$ 453,000
Department of Linguistics	\$ 255,603	\$ 169,499
Department of Mathematics	\$ 2,347,746	\$ 936,277
Department of Physics	\$ 4,764,591	\$ 3,823,743
Department of Political Science	\$ 1,254,910	\$ 389,400
Department of Psychology	\$ 6,080,881	\$ 4,446,815
Department of Romance Languages	\$0	\$ 8,290
Department of Sociology	\$ 10,350	\$ 15,000
Department of Speech and Hearing Sciences	\$ 795,626	\$ 1,295,988
Department of Statistics	\$ 708,855	\$ 540,437
Henry M. Jackson School of International Studies	\$ 1,713,145	\$ 2,029,787
Institute for Nuclear Theory	\$0	\$ 722,200
Language Learning Center	\$ 76,000	\$ 137,000
Other Arts and Sciences Programs	\$0	\$ 4,033,304
Public Performing Arts	\$ 115,338	\$ 110,029
Thomas Burke Memorial Washington State Museum	\$ 85,495	\$ 67,989
Total :	\$ 49,088,660	\$ 59,057,730

Assuming acceptance of all awards by the Board of Regents

Summary of Grant Awards**Fiscal Year 2008-2009***Excluding private awards from Foundations, Industry, Associations and Others*

Month	RESEARCH AND OTHER		TRAINING		Total Grants
	Federal	Non-Federal	Federal	Non-Federal	
July	\$ 84,699,550	\$ 3,384,315	\$ 9,776,757	\$ 226,080	\$ 98,086,700
August	\$ 53,590,660	\$ 5,137,674	\$ 7,914,685	\$ 0	\$ 66,643,020
September	\$ 90,787,430	\$ 3,932,069	\$ 9,263,558	\$ 164,451	\$ 104,147,500
October	\$ 57,813,560	\$ 8,630,334	\$ 6,130,011	\$ 155,787	\$ 72,729,690
November	\$ 17,799,160	\$ 976,483	\$ 1,145,695	\$ 606,373	\$ 20,527,710
December	\$ 24,735,870	\$ 4,139,161	\$ 102,730	\$ 193,486	\$ 29,171,250
January	\$ 28,120,580	\$ 4,709,648	\$ 1,467,602	\$ 564,443	\$ 34,862,280
Year to Date	\$ 357,546,800	\$ 30,909,680	\$ 35,801,040	\$ 1,910,620	\$ 426,168,200

Assuming acceptance of all awards by the Board of Regents

Summary of Grant Awards**Fiscal Year 2008-2009***Private awards from Foundations, Industry, Associations and Others*

Month	RESEARCH AND OTHER	TRAINING	Total Grants
July	\$ 6,878,668	\$ 512,428	\$ 7,391,096
August	\$ 12,186,370	\$ 397,418	\$ 12,583,790
September	\$ 10,619,370	\$ 83,395	\$ 10,702,760
October	\$ 34,771,180	\$ 440,967	\$ 35,212,150
November	\$ 25,062,730	\$ 1,185,445	\$ 26,248,180
December	\$ 8,611,615	\$ 64,676	\$ 8,676,291
January	\$ 13,484,910	\$ 457,579	\$ 13,942,490
Year to Date	\$ 111,614,800	\$ 3,141,908	\$ 114,756,800

Assuming acceptance of all awards by the Board of Regents

Summary of Contract Awards**Fiscal Year 2008-2009**

Month	RESEARCH AND OTHER			TRAINING		Total Contracts
		Federal	Non-Federal	Federal	Non-Federal	
July	\$ 0	\$ 1,411,756	\$ 5,957,698	\$ 0	\$ 2,263,482	\$ 9,632,936
August	\$ 0	\$ 5,421,129	\$ 5,139,839	\$ 30,000	\$ 638,741	\$ 11,229,710
September	\$ 0	\$ 14,557,370	\$ 5,542,074	\$ 19,000	\$ 843,663	\$ 20,962,110
October	\$ 0	\$ 5,438,786	\$ 8,823,394	\$ 0	\$ 1,683,050	\$ 15,945,230
November	\$ 0	\$ 5,021,777	\$ 7,705,027	\$ 0	\$ 970,363	\$ 13,697,170
December	\$ 0	\$ 9,971,688	\$ 10,212,080	\$ 0	\$ 721,718	\$ 20,905,490
January	\$ 65,233	\$ 2,394,864	\$ 13,116,860	\$ 0	\$ 234,867	\$ 15,811,830
Year to Date	\$ 65,233	\$ 44,217,370	\$ 56,496,970	\$ 49,000	\$ 7,355,885	\$ 108,184,500

Assuming acceptance of all awards by the Board of Regents

Report of Grant and Contract Awards of \$1,000,000 or More

January 2009

**Requiring action of
The Board of Regents
of the
University of Washington**

**Office of Research
Office of Sponsored Programs**

Detail of Public Grant Awards

Federal

US Department of Health and Human Services (DHHS)

Centers for Disease Control and Prevention (CDC)

To: Jeffrey R Harris, Professor \$ 1,211,301
Department of Health Services

For: Center for Health Marketing and Communication

Eff: 9/30/2008 Classified: No

Total for Centers for Disease Control and Prevention (CDC): \$ 1,211,301

National Institutes of Health (NIH)

To: John M. Harlan, Professor \$ 2,419,947
Department of Medicine

For: Copy of Copy of BIOLOGY OF THE ARTERY WALL AND
ATHEROSCLEROSIS

Eff: 12/1/2008 Classified: No

To: Ann C Collier, Professor \$ 1,195,071
Department of Medicine

For: University of Washington Clinical HIV Integrated Research Program

Eff: 12/1/2008 Classified: No

National Institute of Diabetes and Digestive and Kidney Diseases (NIDDK)

To: Jerry P Palmer, Professor \$ 1,303,066
Department of Medicine

For: Diabetes Endocrinology Research Center

Eff: 12/1/2008 Classified: No

*Total for National Institute of Diabetes and Digestive and Kidney
Diseases (NIDDK): \$ 1,303,066*

Total for National Institutes of Health (NIH): \$ 4,918,084

Total for US Department of Health and Human Services (DHHS): \$ 6,129,385

Total for Federal: \$ 6,129,385

State of Washington

Washington State Life Sciences Discovery Fund Authority (LSDFA)

To: Eberhard Fetz, Professor \$ 1,068,985
Department of Physiology and Biophysics

For: Brain-computer interfaces for functional recovery from brain injury

Eff: 12/20/2008 Classified: No

**Total for Washington State Life Sciences Discovery Fund Authority
(LSDFA): \$ 1,068,985**

Total for State of Washington: \$ 1,068,985

Total Public Grants: \$ 7,198,370

Detail of Private Grant Awards

Associations and Non-Profits

Joint Oceanographic Institutions, Inc.

To:	John R. Delaney, Professor School of Oceanography	\$ 1,959,727
For:	The University of Washington's Application to Become the Implementing Organization for the Regional Cabled Observatory	
Eff:	3/30/2007	Classified: No

Total for Joint Oceanographic Institutions, Inc.:	\$ 1,959,727
--	---------------------

Total for Associations and Non-Profits:	\$ 1,959,727
--	---------------------

Foundations

Carnegie Corporation of New York

To:	Paul T. Hill, Research Professor Bothell Arts & Sciences	\$ 1,200,000
For:	Carnegie Foundation Study	
Eff:	1/1/2009	Classified: No

Total for Carnegie Corporation of New York:	\$ 1,200,000
--	---------------------

Total for Foundations:	\$ 1,200,000
-------------------------------	---------------------

Total Private Grants:	\$ 3,159,727
------------------------------	---------------------

Detail of Contract Awards

State of Washington

Washington State Department of Health

To: Neil Rambo, Acting Associate Dean Of Library \$ 6,792,485
Library

For: HEAL-WA DOH Contract # N17243

Eff: 12/10/2008

Classified: No

Total for Washington State Department of Health: \$ 6,792,485

Total for State of Washington: \$ 6,792,485

Total Contracts: \$ 6,792,485

Grand Total for all Awards \$ 17,150,582

Grant and Contract Awards Summary

to

The Board of Regents

of the

University of Washington

for

February 2009

Office of Research

Office of Sponsored Programs

Table of Contents

Graphical Summary of Award Activity	3
Summary of Grant and Contract Awards	4
Comparison of Grants and Contract Awards by Agency	5
Comparison of Grants and Contract Awards by School/College	6
Listing of Awards for College of Arts and Sciences by Department	7
Summary of Grant Awards – Excluding Private Awards	8
Summary of Grant Awards - Private Awards	9
Summary of Contract Awards	10
Report of Grant & Contract Awards over \$1,000,000	11

February Only
Comparison of Grant & Contract Awards



Fiscal Year to Date
Comparison of Grant & Contract Awards

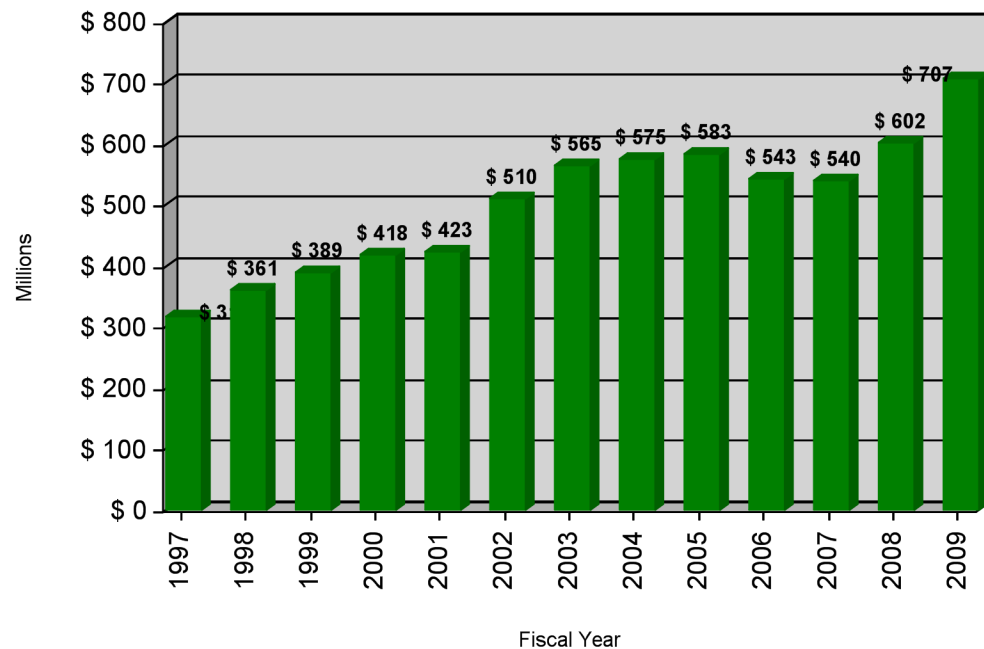

Complete Fiscal Year
Comparison of Grant & Contract Awards

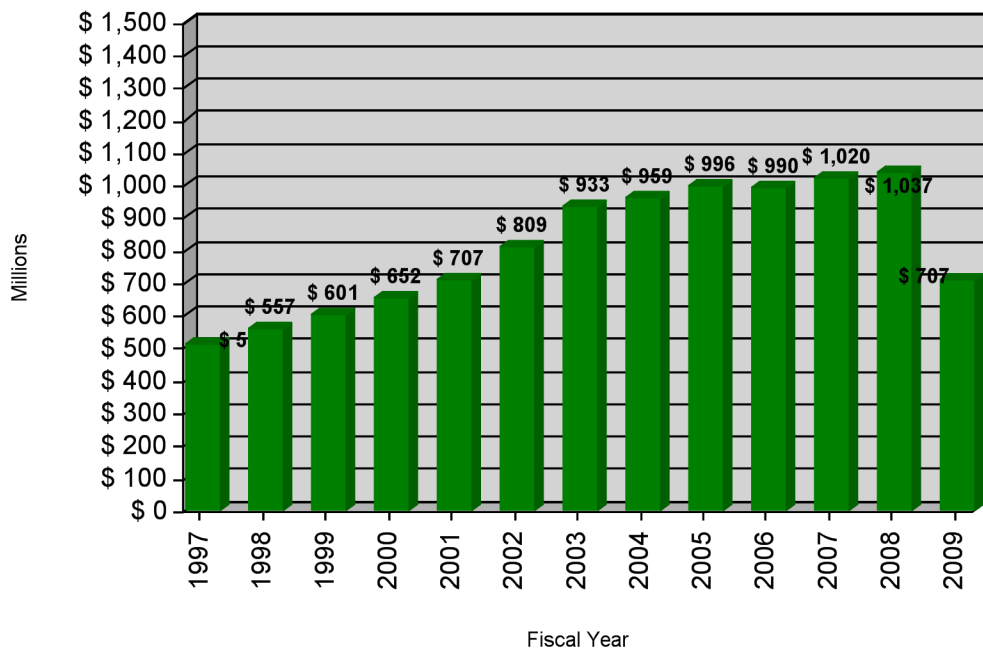

Fiscal Year to Date
Two-Year Comparison of Grant and Contract Awards

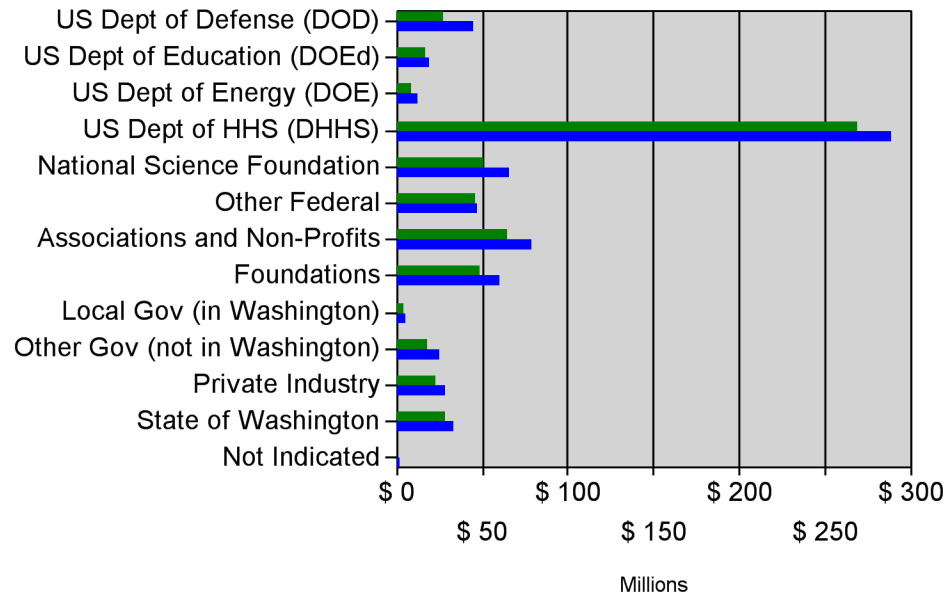

Jul-Feb FY08 Jul-Feb FY09

Summary of Grant and Contract Awards

Fiscal Year 2008-2009

Month	RESEARCH AND OTHER		TRAINING		Total Grants and Contracts
	Federal	Non-Federal	Federal	Non-Federal	
July	\$ 86,111,310	\$ 16,220,680	\$ 9,776,757	\$ 3,001,990	\$ 115,110,700
August	\$ 59,011,790	\$ 22,463,880	\$ 7,944,685	\$ 1,036,159	\$ 90,456,520
September	\$ 105,344,800	\$ 20,093,510	\$ 9,282,558	\$ 1,091,509	\$ 135,812,400
October	\$ 63,252,340	\$ 52,224,910	\$ 6,130,011	\$ 2,279,804	\$ 123,887,100
November	\$ 22,820,940	\$ 33,744,240	\$ 1,145,695	\$ 2,762,181	\$ 60,473,060
December	\$ 34,707,560	\$ 22,962,860	\$ 102,730	\$ 979,880	\$ 58,753,020
January	\$ 30,515,450	\$ 31,376,650	\$ 1,467,602	\$ 1,256,889	\$ 64,616,590
February	\$ 38,533,780	\$ 16,592,700	\$ 1,260,230	\$ 1,539,639	\$ 57,926,360
<hr/>					
FY09 to Date	\$440,233,897	\$215,743,515	\$37,110,268	\$13,948,051	\$707,035,732
FY08 to Date	\$379,987,636	\$166,727,213	\$36,983,895	\$18,131,856	\$601,830,601
Over (Under) Previous Year	\$60,246,261	\$49,016,302	\$126,373	(\$4,183,805)	\$105,205,131

Assuming acceptance of all awards by the Board of Regents

Comparison of Grant and Contract Awards by Agency

Fiscal Years 2007-2008 and 2008-2009

Agency	Jul-Feb FY08	Jul-Feb FY09
US Department of Defense (DOD)	\$ 27,307,726	\$ 44,954,601
US Department of Education (DOEd)	\$ 16,459,371	\$ 19,418,108
US Department of Energy (DOE)	\$ 8,557,625	\$ 12,081,032
US Department of Health and Human Services (DHHS)	\$ 268,745,301	\$ 287,977,487
National Science Foundation (NSF)	\$ 50,314,273	\$ 65,737,486
Other Federal	\$ 45,587,235	\$ 47,175,451
Subtotal for Federal :	\$ 416,971,532	\$ 477,344,165
Associations and Non-Profits	\$ 64,048,571	\$ 78,545,564
Foundations	\$ 48,375,709	\$ 59,353,729
Local Government (in Washington)	\$ 4,488,143	\$ 5,191,138
Other Government (not in Washington)	\$ 17,460,816	\$ 25,437,070
Private Industry	\$ 22,282,296	\$ 28,371,894
State of Washington	\$ 28,203,534	\$ 32,769,613
Not Indicated	\$ 0	\$ 22,559
Subtotal for Non-Federal :	\$ 184,859,069	\$ 229,691,566
Grand Total :	\$ 601,830,601	\$ 707,035,732
Amount of Increase (Decrease) :		\$ 105,205,131
Percent of Increase (Decrease) :		17.5 %

Assuming acceptance of all awards by the Board of Regents

Comparison of Grant and Contract Awards by School/College

Fiscal Years 2007-2008 and 2008-2009

School/College		Jul-Feb FY08	Jul-Feb FY09
Upper Campus			
	Architecture and Urban Planning	\$ 684,190	\$ 1,526,544
	Arts and Sciences	\$ 56,073,396	\$ 65,304,197
	Business Administration	\$ 740,458	\$ 770,000
	Director of Libraries	\$ 116,500	\$ 6,860,485
	Education	\$ 2,929,345	\$ 9,057,292
	Educational Outreach	\$ 287,668	\$ 96,400
	Engineering	\$ 47,421,772	\$ 58,356,870
	Evans School of Public Affairs	\$ 2,633,560	\$ 2,466,013
	Executive Vice President	\$ 208,000	\$ 621,238
	Forest Resources	\$ 4,210,560	\$ 6,468,373
	Graduate School	\$ 1,018,655	\$ 4,436,854
	Information School	\$ 5,321,806	\$ 4,873,483
	Law	\$ 345,734	\$ 1,653,453
	Ocean and Fishery Sciences	\$ 56,717,242	\$ 63,393,906
	Office of Research	\$ 17,739,360	\$ 16,601,797
	Provost	\$ 200,000	\$ 112,947
	Social Work	\$ 8,766,657	\$ 9,700,450
	Undergraduate Education	\$ 326,802	\$ 234,944
	VP Educational Partnerships	\$ 43,745	\$ 30,000
	VP Minority Affairs	\$ 7,034,709	\$ 6,612,603
	Subtotal :	\$ 212,820,159	\$ 259,177,848
Health Sciences			
	Dentistry	\$ 6,145,132	\$ 6,509,505
	Medicine	\$ 290,381,022	\$ 348,773,001
	Nursing	\$ 9,964,325	\$ 8,436,611
	Pharmacy	\$ 5,800,333	\$ 7,120,375
	Public Health and Community Medicine	\$ 48,249,702	\$ 47,232,843
	Subtotal :	\$ 360,540,515	\$ 418,072,335
Special Programs			
	Alcohol and Drug Abuse Institute	\$ 3,192,422	\$ 2,127,747
	CHDD Administration	\$ 7,571,760	\$ 5,061,478
	Regional Primate Center	\$ 16,158,609	\$ 18,862,641
	Subtotal :	\$ 26,922,791	\$ 26,051,866
Other UW Campuses			
	Bothell	\$ 1,193,411	\$ 3,198,925
	Tacoma	\$ 218,450	\$ 509,838
	Subtotal :	\$ 1,411,861	\$ 3,708,763
Not Indicated	Not Indicated	\$ 135,275	\$ 24,000

School/College		Jul-Feb FY08	Jul-Feb FY09
Not Indicated	Tacoma		\$ 920
	Subtotal :	\$ 135,275	\$ 24,920
	Grand Total :	\$ 601,830,601	\$ 707,035,732

Assuming acceptance of all awards by the Board of Regents

List of Awards for Arts and Sciences

Fiscal Years 2007-2008 and 2008-2009

Department	Jul-Feb FY08	Jul-Feb FY09
Center for Humanities	\$0	\$ 625,000
Center for Statistics and the Social Sciences	\$ 736,119	\$ 96,213
Center for Studies in Demography and Ecology	\$ 1,907,361	\$ 1,824,263
Dance Program	\$0	\$ 10,000
Department of Anthropology	\$ 249,016	\$ 353,001
Department of Applied Mathematics	\$ 28,629	\$ 657,408
Department of Asian Languages and Literature	\$0	\$ 100,000
Department of Astronomy	\$ 4,050,189	\$ 6,923,444
Department of Atmospheric Sciences	\$ 2,979,547	\$ 3,915,829
Department of Biology	\$ 3,557,690	\$ 6,163,631
Department of Chemistry	\$ 16,561,470	\$ 17,065,820
Department of Classics	\$0	\$ 2,000
Department of Communication	\$ 1,395,680	\$ 794,365
Department of Earth and Space Sciences	\$ 3,745,167	\$ 5,351,341
Department of Economics	\$ 6,575	\$ 63,560
Department of English	\$ 77,573	\$ 56,000
Department of Geography	\$ 336,787	\$ 12,000
Department of Germanics	\$ 98,000	\$0
Department of History	\$0	\$ 453,000
Department of Linguistics	\$ 255,603	\$ 169,499
Department of Mathematics	\$ 2,347,746	\$ 936,277
Department of Physics	\$ 4,882,591	\$ 3,823,743
Department of Political Science	\$ 1,254,910	\$ 401,390
Department of Psychology	\$ 6,924,835	\$ 4,746,268
Department of Romance Languages	\$0	\$ 8,290
Department of Sociology	\$ 10,350	\$ 15,000
Department of Speech and Hearing Sciences	\$ 1,032,062	\$ 1,295,988
Department of Statistics	\$ 708,855	\$ 540,437
Gaining Early Awareness and Readiness for Undergraduate Programs	\$ 790,660	\$ 750,000
Henry M. Jackson School of International Studies	\$ 1,713,145	\$ 2,954,909
Institute for Nuclear Theory	\$ 111,000	\$ 722,200
Language Learning Center	\$ 76,000	\$ 137,000
Other Arts and Sciences Programs	\$0	\$ 4,133,304
Public Performing Arts	\$ 150,338	\$ 135,029
Thomas Burke Memorial Washington State Museum	\$ 85,495	\$ 67,989
Total :	\$ 56,073,400	\$ 65,304,200

Assuming acceptance of all awards by the Board of Regents

Summary of Grant Awards**Fiscal Year 2008-2009***Excluding private awards from Foundations, Industry, Associations and Others*

Month	RESEARCH AND OTHER		TRAINING		Total Grants
	Federal	Non-Federal	Federal	Non-Federal	
July	\$ 84,699,550	\$ 3,384,315	\$ 9,776,757	\$ 226,080	\$ 98,086,700
August	\$ 53,590,660	\$ 5,137,674	\$ 7,914,685	\$ 0	\$ 66,643,020
September	\$ 90,787,430	\$ 3,932,069	\$ 9,263,558	\$ 164,451	\$ 104,147,500
October	\$ 57,813,560	\$ 8,630,334	\$ 6,130,011	\$ 155,787	\$ 72,729,690
November	\$ 17,799,160	\$ 976,483	\$ 1,145,695	\$ 606,373	\$ 20,527,710
December	\$ 24,735,870	\$ 4,139,161	\$ 102,730	\$ 193,486	\$ 29,171,250
January	\$ 28,120,580	\$ 4,709,648	\$ 1,467,602	\$ 564,443	\$ 34,862,280
February	\$ 34,469,790	\$ 1,543,840	\$ 1,260,230	\$ 0	\$ 37,273,860
Year to Date	\$ 392,016,600	\$ 32,453,520	\$ 37,061,270	\$ 1,910,620	\$ 463,442,000

Assuming acceptance of all awards by the Board of Regents

Summary of Grant Awards**Fiscal Year 2008-2009***Private awards from Foundations, Industry, Associations and Others*

Month	RESEARCH AND OTHER	TRAINING	Total Grants
July	\$ 6,878,668	\$ 512,428	\$ 7,391,096
August	\$ 12,186,370	\$ 397,418	\$ 12,583,790
September	\$ 10,619,370	\$ 83,395	\$ 10,702,760
October	\$ 34,771,180	\$ 440,967	\$ 35,212,150
November	\$ 25,062,730	\$ 1,185,445	\$ 26,248,180
December	\$ 8,611,615	\$ 64,676	\$ 8,676,291
January	\$ 13,484,910	\$ 457,579	\$ 13,942,490
February	\$ 9,137,721	\$ 90,027	\$ 9,227,748
Year to Date	\$ 120,752,600	\$ 3,231,935	\$ 123,984,500

Assuming acceptance of all awards by the Board of Regents

Summary of Contract Awards**Fiscal Year 2008-2009**

Month	RESEARCH AND OTHER			TRAINING		Total Contracts
		Federal	Non-Federal	Federal	Non-Federal	
July	\$ 0	\$ 1,411,756	\$ 5,957,698	\$ 0	\$ 2,263,482	\$ 9,632,936
August	\$ 0	\$ 5,421,129	\$ 5,139,839	\$ 30,000	\$ 638,741	\$ 11,229,710
September	\$ 0	\$ 14,557,370	\$ 5,542,074	\$ 19,000	\$ 843,663	\$ 20,962,110
October	\$ 0	\$ 5,438,786	\$ 8,823,394	\$ 0	\$ 1,683,050	\$ 15,945,230
November	\$ 0	\$ 5,021,777	\$ 7,705,027	\$ 0	\$ 970,363	\$ 13,697,170
December	\$ 0	\$ 9,971,688	\$ 10,212,080	\$ 0	\$ 721,718	\$ 20,905,490
January	\$ 65,233	\$ 2,394,864	\$ 13,116,860	\$ 0	\$ 234,867	\$ 15,811,830
February	\$ 271,900	\$ 4,063,997	\$ 5,639,242	\$ 0	\$ 1,449,612	\$ 11,424,750
Year to Date	\$ 337,133	\$ 48,281,360	\$ 62,136,220	\$ 49,000	\$ 8,805,496	\$ 119,609,200

Assuming acceptance of all awards by the Board of Regents

Report of Grant and Contract Awards of \$1,000,000 or More

February 2009

**Requiring action of
The Board of Regents
of the
University of Washington**

**Office of Research
Office of Sponsored Programs**

Detail of Public Grant Awards

Federal

US Department of Defense (DOD)

US Army Research Office (ARO)

To: Pedro Morais Domingos, Associate Professor
Computer Science and Engineering \$ 1,250,000

For: A Unified Approach to Abductive Inference

Eff: 6/2/2008

Classified: No

Total for US Army Research Office (ARO): \$ 1,250,000

Total for US Department of Defense (DOD): \$ 1,250,000

National Science Foundation (NSF)

National Science Foundation (NSF)

To: John D Bransford, Professor
Department of Education \$ 2,499,038

For: The LIFE Center: Learning in Informal and Formal Environments

Eff: 10/1/2008

Classified: No

Total for National Science Foundation (NSF): \$ 2,499,038

Total for National Science Foundation (NSF): \$ 2,499,038

Other Federal

National Sea Grant College Program

To: Penelope Dalton, Director
Marine Environmental and Resource Programs / Washington Sea Grant \$ 2,126,535

For: Program Plan for Renewal of Sea Grant College Support 2007-2010

Eff: 2/1/2009

Classified: No

Total for National Sea Grant College Program: \$ 2,126,535

Total for Other Federal: \$ 2,126,535

Total for Federal: \$ 5,875,573

Total Public Grants: \$ 5,875,573

Detail of Private Grant Awards

Associations and Non-Profits

Fred Hutchinson Cancer Research Center (FHCRC)

To: James I. Mullins, Professor \$ 1,050,355
Department of Microbiology

For: Sequencing of Breakthrough Infections from the STEP Study

Eff: 6/1/2008 Classified: No

Total for Fred Hutchinson Cancer Research Center (FHCRC): \$ 1,050,355

Total for Associations and Non-Profits: \$ 1,050,355

Total Private Grants: \$ 1,050,355

Detail of Contract Awards

Federal

US Department of Defense (DOD)

US Navy

To: Frederick W Karig, Apl-principal Engineer \$ 1,278,000
Applied Physics Laboratory

For: ICEX09 PREP AND CAMP (TO# 0096-02) 3rd increment

Eff: 7/11/2008 Classified: Yes

Total for US Navy: \$ 1,278,000

Total for US Department of Defense (DOD): \$ 1,278,000

Total for Federal: \$ 1,278,000

Total Contracts: \$ 1,278,000

Grand Total for all Awards \$ 8,203,928

VII. STANDING COMMITTEES

B. Finance, Audit and Facilities Committee

UW

**Report of
Contributions**

University of Washington
University of Washington Foundation

February, 2009



UNIVERSITY OF WASHINGTON

All Areas

REPORT OF CONTRIBUTIONS

February 2009

REPORT BY: UNIVERSITY ADVANCEMENT, ADVANCEMENT SERVICES, INFORMATION MANAGEMENT

ANNUAL PROGRESS BY CONSTITUENCY

School	Current Month				Year to Date			
	Gifts	Grants	Total	Donors ¹	Gifts	Grants	Total	Donors
UW Medicine	\$2,817,081	\$5,280,164	\$8,097,245	2,217	\$24,248,661	\$69,778,940	\$94,027,602	12,151
Arts and Sciences	\$482,928	\$640,349	\$1,123,277	1,221	\$11,811,133	\$5,234,337	\$17,045,469	11,276
Broadcast Services	\$628,931	\$0	\$628,931	258	\$2,351,404	\$0	\$2,351,404	1,249
Built Environments	\$11,879	\$5,000	\$16,879	68	\$931,703	\$927,500	\$1,859,203	949
Business School	\$1,238,299	\$0	\$1,238,299	191	\$19,747,480	\$0	\$19,747,480	3,284
Dentistry	\$47,411	\$109,188	\$156,599	125	\$1,010,709	\$613,147	\$1,623,856	1,046
Education	\$97,474	\$0	\$97,474	187	\$2,003,018	\$942,794	\$2,945,812	1,167
Engineering	\$374,650	\$953,229	\$1,327,879	237	\$8,953,848	\$4,097,609	\$13,051,458	3,427
Environment	\$0	\$0	\$0	0	\$4,663,494	\$0	\$4,663,494	22
Evans School of Public Affairs	\$81,823	\$157,500	\$239,323	50	\$442,716	\$1,112,500	\$1,555,216	304
Forest Resources	\$6,803	\$112,653	\$119,456	87	\$551,323	\$1,161,493	\$1,712,816	685
Friday Harbor Labs	\$1,883	\$0	\$1,883	12	\$1,110,938	\$0	\$1,110,938	295
Information School	\$90,295	\$0	\$90,295	39	\$568,288	\$512,000	\$1,080,288	511
Intercollegiate Athletics	\$2,510,767	\$0	\$2,510,767	5,316	\$8,569,120	\$0	\$8,569,120	10,652
Minority Affairs	\$3,626	\$0	\$3,626	120	\$116,155	\$200,000	\$316,155	290
Law	\$35,683	\$0	\$35,683	100	\$2,193,649	\$0	\$2,193,649	1,448
Libraries	\$51,823	\$0	\$51,823	927	\$721,205	\$0	\$721,205	2,259
Nursing	\$57,276	\$0	\$57,276	129	\$1,871,144	\$743,950	\$2,615,094	1,352
Ocean and Fishery Sciences	\$217,885	\$23,668	\$241,553	104	\$1,181,444	\$7,706,850	\$8,888,294	617
Pharmacy	\$87,297	\$1,932	\$89,229	163	\$745,243	\$598,870	\$1,344,113	757
President's Funds	\$28,894	\$0	\$28,894	220	\$2,824,239	\$0	\$2,824,239	1,336
Public Health	\$21,660	\$1,352,088	\$1,373,747	181	\$654,527	\$10,891,572	\$11,546,099	602
Social Work	\$1,439	\$0	\$1,439	32	\$121,178	\$50,100	\$171,278	593
Student Affairs	\$193,162	\$0	\$193,162	213	\$1,132,393	\$0	\$1,132,393	1,870
Undergraduate Academic Affairs	\$2,210	\$0	\$2,210	27	\$376,371	\$20,000	\$396,371	237
University Press	\$5,910	\$0	\$5,910	34	\$145,215	\$0	\$145,215	133
UW Alumni Association	\$52,062	\$0	\$52,062	1,076	\$590,602	\$0	\$590,602	11,757
UW Bothell	\$14,540	\$0	\$14,540	160	\$238,646	\$1,575,000	\$1,813,646	383
UW Tacoma	\$143,851	\$0	\$143,851	151	\$1,558,398	\$23,965	\$1,582,363	492
Other University Support	\$632,453	\$60,626	\$693,079	103	\$2,338,260	\$478,046	\$2,816,306	1,702
Total	\$9,939,995	\$8,696,397	\$18,636,392	13,159	\$103,772,505	\$106,668,673	\$210,441,178	62,987

MONTHLY HIGHLIGHTS

The UW received \$18.64M in total private voluntary support (\$9.94M in gifts and \$8.70M in grants) in the current month.

Areas including Built Environments, Business School, Dentistry, Education, Environment, Forest Resources, Friday Harbor Labs, Minority Affairs, Law, Nursing, Public Health, Student Affairs, Undergraduate Academic Affairs and UW Bothell are ahead of last year's year-to-date totals.

¹ Donors are defined as those entities who have a credit amount of greater than \$0.00.

The donor total at the bottom of the chart is not a cumulative total of the rows above. The donor total is the number of unique donors who have been credited with a gift to the UW during the given time period.

Source: University Advancement, Information Management Report # devrpts_s09032

DEVELOPMENT SUMMARY BY CONSTITUENCY

School	Current Month		Year to Date		Prior Year to Date		Prior Year Total	
	Total	Donors	Total	Donors	Total	Donors	Total	Donors
UW Medicine	\$8,097,245	2,217	\$94,027,602	12,151	\$96,432,581	14,419	\$128,084,404	18,602
Arts and Sciences	\$1,123,277	1,221	\$17,045,469	11,276	\$22,572,804	11,302	\$36,159,265	15,040
Broadcast Services	\$628,931	258	\$2,351,404	1,249	\$6,939,875	11,857	\$12,124,630	21,710
Built Environments	\$16,879	68	\$1,859,203	949	\$1,393,558	964	\$2,552,681	1,467
Business School	\$1,238,299	191	\$19,747,480	3,284	\$10,409,293	3,904	\$13,215,754	4,667
Dentistry	\$156,599	125	\$1,623,856	1,046	\$1,079,750	1,116	\$3,479,430	1,340
Education	\$97,474	187	\$2,945,812	1,167	\$2,393,091	1,181	\$2,778,307	1,637
Engineering	\$1,327,879	237	\$13,051,458	3,427	\$14,765,137	3,754	\$22,826,602	4,653
Environment	\$0	0	\$4,663,494	22	\$0	0	\$0	0
Evans School of Public Affairs	\$239,323	50	\$1,555,216	304	\$2,579,316	276	\$3,350,952	493
Forest Resources	\$119,456	87	\$1,712,816	685	\$1,672,757	870	\$2,552,419	1,151
Friday Harbor Labs	\$1,883	12	\$1,110,938	295	\$410,565	385	\$553,591	454
Information School	\$90,295	39	\$1,080,288	511	\$3,075,828	544	\$3,893,390	639
Intercollegiate Athletics	\$2,510,767	5,316	\$8,569,120	10,652	\$12,813,978	11,787	\$20,268,275	25,073
Minority Affairs	\$3,626	120	\$316,155	290	\$0	0	\$0	0
Law	\$35,683	100	\$2,193,649	1,448	\$1,807,665	1,710	\$2,865,343	2,166
Libraries	\$51,823	927	\$721,205	2,259	\$1,211,373	2,442	\$1,599,016	4,714
Nursing	\$57,276	129	\$2,615,094	1,352	\$2,386,875	1,417	\$3,155,721	1,775
Ocean and Fishery Sciences	\$241,553	104	\$8,888,294	617	\$9,088,870	625	\$12,310,301	829
Pharmacy	\$89,229	163	\$1,344,113	757	\$2,313,293	897	\$3,038,164	1,127
President's Funds	\$28,894	220	\$2,824,239	1,336	\$439,875	1,624	\$961,234	2,240
Public Health	\$1,373,747	181	\$11,546,099	602	\$7,472,310	571	\$9,774,188	732
Scholarships and Student Programs	\$0	0	\$0	0	\$6,119,369	4,821	\$7,075,190	6,407
Social Work	\$1,439	32	\$171,278	593	\$1,371,051	721	\$1,633,711	895
Student Affairs	\$193,162	213	\$1,132,393	1,870	\$0	0	\$0	0
Undergraduate Academic Affairs	\$2,210	27	\$396,371	237	\$0	0	\$0	0
University Press	\$5,910	34	\$145,215	133	\$300,192	264	\$414,094	293
UW Alumni Association	\$52,062	1,076	\$590,602	11,757	\$628,810	12,449	\$1,146,912	21,851
UW Bothell	\$14,540	160	\$1,813,646	383	\$107,044	299	\$302,577	795
UW Tacoma	\$143,851	151	\$1,582,363	492	\$2,156,558	471	\$4,420,119	967
Other University Support	\$693,079	103	\$2,816,306	1,702	\$3,714,416	1,395	\$4,423,387	2,518
Total ¹	\$18,636,392	13,159	\$210,441,178	62,987	\$215,656,237	79,650	\$304,959,657	121,447

¹ The donor total at the bottom of the chart is not a cumulative total of the rows above. The donor total is the number of unique donors who have been credited with a gift to the UW during the given time period.

FISCAL YEAR COMPARISON OF TOTAL CONTRIBUTIONS

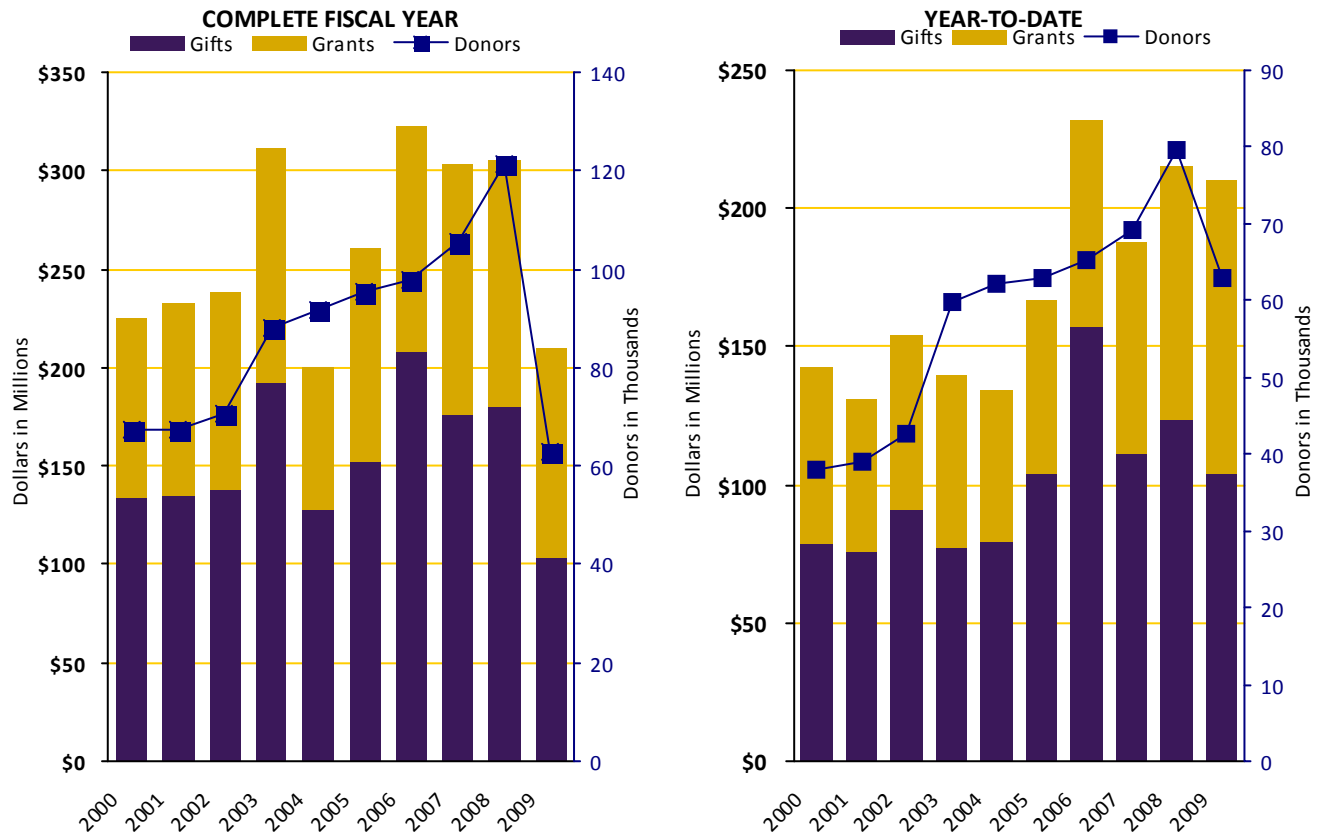

Fiscal Year	Complete Fiscal Year				Year to Date			
	Gifts	Grants	Total	Donors	Gifts	Grants	Total	Donors
2008-2009	\$103,772,505	\$106,668,673	\$210,441,178	62,987	\$103,772,505	\$106,668,673	\$210,441,178	62,987
2007-2008	\$180,735,444	\$124,224,214	\$304,959,657	121,447	\$123,716,605	\$91,939,632	\$215,656,237	79,650
2006-2007	\$176,490,215	\$126,399,369	\$302,889,584	105,353	\$111,462,184	\$76,621,679	\$188,083,863	69,266
2005-2006	\$207,744,231	\$115,261,186	\$323,005,417	97,876	\$157,615,928	\$74,294,061	\$231,909,989	65,298
2004-2005	\$151,969,925	\$108,802,371	\$260,772,296	95,227	\$104,192,263	\$62,566,371	\$166,758,634	62,962
2003-2004	\$128,174,367	\$71,603,323	\$199,777,690	91,903	\$79,239,120	\$55,390,822	\$134,629,942	62,105
2002-2003	\$192,573,183	\$118,677,722	\$311,250,905	88,259	\$77,350,454	\$62,155,003	\$139,505,457	59,895
2001-2002	\$137,959,340	\$100,820,547	\$238,779,887	70,560	\$91,058,605	\$62,829,546	\$153,888,151	42,684
2000-2001	\$134,797,642	\$97,112,979	\$231,910,621	67,307	\$75,899,927	\$54,792,444	\$130,692,371	39,011
1999-2000	\$134,037,997	\$91,536,165	\$225,574,162	67,351	\$78,708,694	\$63,378,435	\$142,087,129	37,962

ANNUAL FUNDING THEME PROGRESS

Theme	Year to Date		
	Current Use	Endowment	Total
Student Support	\$5,166,535	\$12,421,534	\$17,588,069
Faculty Support	\$4,112,447	\$10,782,036	\$14,894,483
Program Support for Faculty and Students	\$127,710,609	\$17,170,637	\$144,881,246
Capital	\$14,607,236	\$700	\$14,607,936
Excellence Funds	\$16,946,170	\$1,523,274	\$18,469,444
Total	\$168,542,997	\$41,898,181	\$210,441,178

DEVELOPMENT ACTIVITY BY DONOR TYPE

Donor Type	Year to Date		Prior Year to Date		Prior Fiscal Year	
	Donors	Total	Donors	Total	Donors	Total
Alumni	34,272	\$27,078,342	38,880	\$41,992,233	55,089	\$57,128,097
Corporations	1,906	\$34,463,774	2,205	\$44,028,702	3,255	\$61,590,177
Family Foundations	143	\$10,550,781	143	\$9,443,296	172	\$13,349,493
Foundations	313	\$61,929,235	325	\$58,502,123	431	\$75,371,489
Non-Alumni	25,919	\$30,226,445	37,798	\$23,577,057	61,914	\$40,209,765
Organizations	434	\$46,192,600	415	\$38,112,826	586	\$57,285,487
Total	62,987	\$210,441,178	79,766	\$215,656,237	121,447	\$304,934,507

DEVELOPMENT ACTIVITY PYRAMID

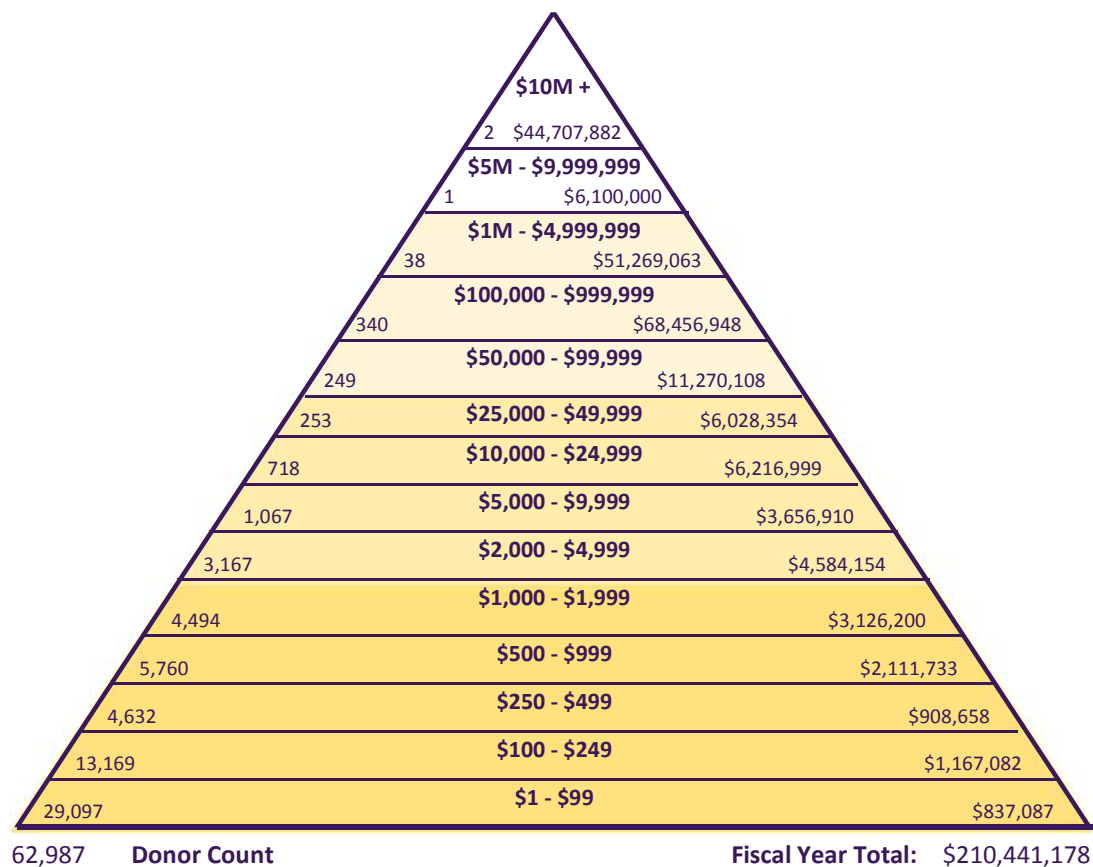

ANNUAL PROGRESS BY GIVING LEVEL

Giving Level	Alumni	Non Alumni	Family Fndns.	Corporations	Foundations	Other Orgs.	Total
\$10M +	\$0	\$0	\$0	\$0	\$30,525,625	\$14,182,257	\$44,707,882
\$5M - \$9,999,999	\$0	\$6,100,000	\$0	\$0	\$0	\$0	\$6,100,000
\$1M - \$4,999,999	\$6,388,524	\$6,727,818	\$5,410,043	\$9,529,068	\$11,166,912	\$12,046,697	\$51,269,063
\$100,000 - \$999,999	\$8,427,019	\$8,820,069	\$3,799,189	\$14,799,151	\$16,205,045	\$16,406,476	\$68,456,948
\$50,000 - \$99,999	\$1,328,574	\$1,202,400	\$422,961	\$4,223,192	\$2,370,714	\$1,722,267	\$11,270,108
\$25,000 - \$49,999	\$942,366	\$971,752	\$373,475	\$2,125,287	\$840,869	\$774,605	\$6,028,354
\$10,000 - \$24,999	\$1,695,190	\$1,169,848	\$356,426	\$1,789,179	\$559,461	\$646,896	\$6,216,999
\$5,000 - \$9,999	\$1,444,099	\$894,130	\$106,804	\$875,488	\$126,781	\$209,610	\$3,656,910
\$2,000 - \$4,999	\$2,302,077	\$1,419,249	\$56,850	\$603,563	\$78,042	\$124,373	\$4,584,154
\$1,000 - \$1,999	\$1,534,897	\$1,186,470	\$21,932	\$298,921	\$36,928	\$47,052	\$3,126,200
\$500 - \$999	\$1,176,163	\$764,824	\$2,550	\$138,821	\$10,429	\$18,946	\$2,111,733
\$250 - \$499	\$537,223	\$322,719	\$250	\$37,367	\$3,442	\$7,656	\$908,658
\$100 - \$249	\$730,050	\$393,528	\$300	\$34,166	\$4,455	\$4,584	\$1,167,082
\$1 - \$99	\$572,160	\$253,639	\$0	\$9,573	\$535	\$1,180	\$837,087
Total	\$27,078,342	\$30,226,445	\$10,550,781	\$34,463,774	\$61,929,235	\$46,192,600	\$210,441,178

Giving Level	Alumni	Non Alumni	Family Fndns.	Corporations	Foundations	Other Orgs.	Total
\$10M +	0	0	0	0	1	1	2
\$5M - \$9,999,999	0	1	0	0	0	0	1
\$1M - \$4,999,999	7	9	3	7	5	7	38
\$100,000 - \$999,999	61	84	24	70	54	47	340
\$50,000 - \$99,999	52	65	8	61	35	28	249
\$25,000 - \$49,999	49	78	13	63	27	23	253
\$10,000 - \$24,999	208	279	24	125	41	41	718
\$5,000 - \$9,999	430	406	22	153	20	36	1,067
\$2,000 - \$4,999	1,460	1,373	20	240	27	47	3,167
\$1,000 - \$1,999	2,013	2,135	20	259	30	37	4,494
\$500 - \$999	2,842	2,615	4	249	18	32	5,760
\$250 - \$499	2,375	2,087	1	133	11	25	4,632
\$100 - \$249	7,194	5,629	4	274	28	40	13,169
\$1 - \$99	17,581	11,158	0	272	16	70	29,097
Total	34,272	25,919	143	1,906	313	434	62,987

ALUMNI PARTICIPATION BY CONSTITUENCY (CURRENT FISCAL YEAR)

Area	Solicitable	To UW		To Unit	
		Year to Date		Year to Date	
		Donors	Part Rate	Donors	Part Rate
UW Medicine	19,109	2,474	12.95%	1,773	9.28%
Arts and Sciences	145,069	14,274	9.84%	5,850	4.03%
Business School	37,913	5,112	13.48%	1,924	5.07%
Built Environments	8,096	980	12.10%	590	7.29%
Dentistry	4,501	859	19.08%	503	11.18%
Education	18,944	2,400	12.67%	560	2.96%
Engineering	32,856	3,542	10.78%	1,924	5.86%
Evans School of Public Affairs	2,394	320	13.37%	146	6.10%
Forest Resources	4,601	425	9.24%	264	5.74%
Interdisc. Grad. Programs	1,719	178	10.35%		
Interdisc. Undergrad. Programs	247	17	6.88%		
Interschool Programs	493	50	10.14%		
Information School	4,516	676	14.97%	343	7.60%
Law	7,755	1,291	16.65%	863	11.13%
School of Nursing	8,661	1,350	15.59%	930	10.74%
Ocean & Fisheries	4,038	498	12.33%	325	8.05%
Pharmacy	3,529	630	17.85%	519	14.71%
Public Health	4,465	555	12.43%	255	5.71%
Social Work	6,428	708	11.01%	458	7.13%
UW Bothell	6,635	511	7.70%	275	4.14%
UW Tacoma	7,685	452	5.88%	309	4.02%
Unspecified	11,813	1,482	12.55%		
ALL UW TOTAL	314,219	34,272	10.91%		

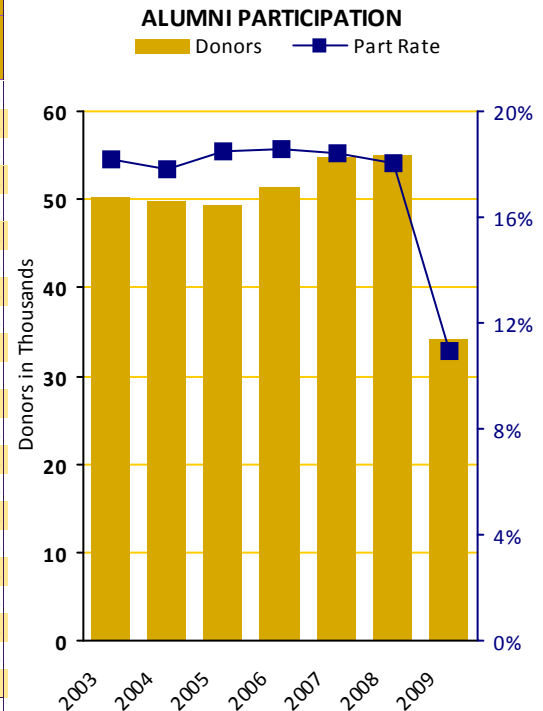

ALUMNI PARTICIPATION BY CONSTITUENCY (PREVIOUS FISCAL YEAR)

Area	Solicitable	To UW				To Unit			
		Year to Date		FY Total		Year to Date		FY Total	
		Donors	Part Rate	Donors	Part Rate	Donors	Part Rate	Donors	PFFY Final
UW Medicine	18,010	2,693	14.95%	3,822	21.22%	1,720	9.55%	2,243	12.45%
Arts and Sciences	141,595	15,572	11.00%	23,047	16.28%	4,836	3.42%	5,948	4.20%
Business School	37,430	5,713	15.26%	8,231	21.99%	2,174	5.81%	2,559	6.84%
Built Environments	7,965	1,044	13.11%	1,563	19.62%	472	5.93%	617	7.75%
Dentistry	4,579	933	20.38%	1,215	26.53%	521	11.38%	627	13.69%
Education	18,902	2,711	14.34%	3,870	20.47%	462	2.44%	589	3.12%
Engineering	32,393	3,953	12.20%	5,569	17.19%	1,897	5.86%	2,310	7.13%
Evans School of Public Affairs	2,329	368	15.80%	619	26.58%	110	4.72%	190	8.16%
Forest Resources	4,603	507	11.01%	801	17.40%	227	4.93%	324	7.04%
Interdisc. Grad. Programs	1,622	190	11.71%	293	18.06%				
Interdisc. Undergrad. Programs	225	7	3.11%	22	9.78%				
Interschool Programs	453	36	7.95%	70	15.45%				
Information School	4,370	753	17.23%	1,004	22.97%	353	8.08%	405	9.27%
Law	7,780	1,473	18.93%	1,942	24.96%	928	11.93%	1,086	13.96%
School of Nursing	8,598	1,461	16.99%	1,980	23.03%	823	9.57%	1,018	11.84%
Ocean & Fisheries	3,911	527	13.47%	788	20.15%	263	6.72%	331	8.46%
Pharmacy	3,426	736	21.48%	997	29.10%	520	15.18%	648	18.91%
Public Health	4,318	561	12.99%	793	18.36%	217	5.03%	276	6.39%
Social Work	6,404	760	11.87%	1,105	17.25%	391	6.11%	496	7.75%
UW Bothell	6,084	453	7.45%	873	14.35%	138	2.27%	224	3.68%
UW Tacoma	7,003	438	6.25%	927	13.24%	172	2.46%	313	4.47%
Unspecified	10,866	1,688	15.53%	2,433	22.39%				
ALL UW TOTAL	305,971	37,641	12.30%	55,089	18.00%				

Source: University Advancement, Information Management Report # devrpts_s09032

REPORT OF CONTRIBUTIONS, UNIVERSITY OF WASHINGTON February 2009

All Areas

KEY PERFORMANCE INDICATORS

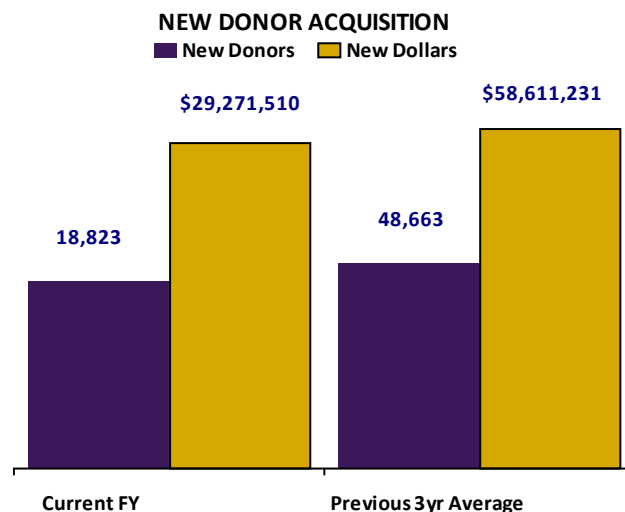

	New Donors	New Dollars
Current FY	18,823	\$29,271,510
Previous 3yr Average	48,663	\$58,611,231

DONOR RETENTION (CURRENT FY)

■ Returning Donor - Decreased Giving
 ■ Returning Donor - Increased Giving
 ■ Returning Donor - Same Giving
 ■ Yet to Return as Donor

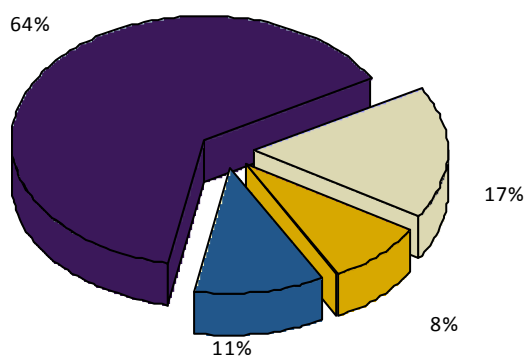

DONOR RETENTION (PREVIOUS 3YR AVG)

■ Returning Donor - Decreased Giving
 ■ Returning Donor - Increased Giving
 ■ Returning Donor - Same Giving
 ■ Yet to Return as Donor

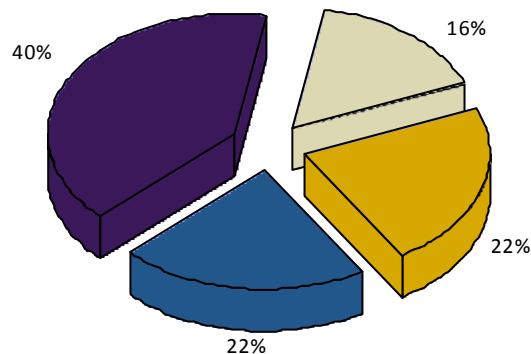

	Donors	Dollars
Returning Donor - Decreased Giving	20,802	\$60,304,609
Returning Donor - Increased Giving	10,085	\$113,487,459
Returning Donor - Same Giving	13,277	\$7,377,601
Yet to Return as Donor	77,275	

	Donors	Dollars
Returning Donor - Decreased Giving	16,124	\$65,278,811
Returning Donor - Increased Giving	22,023	\$178,192,234
Returning Donor - Same Giving	21,414	\$8,169,227
Yet to Return as Donor	39,919	

Donor counts may vary slightly due to donor crediting preferences.

Three-year averages are based on fiscal year totals and do not reflect year-to-date status.

Source: University Advancement, Information Management Report # devrpts_s09032

REPORT OF CONTRIBUTIONS, UNIVERSITY OF WASHINGTON February 2009

All Areas

STATE OF THE DATABASE

School	Alumni	Friends	Total	Mailable	Mail %	Phonable	Phone %	Emailable	Email %	Emp Info	Emp %
UW Medicine	22,619	35,796	58,415	54,164	92.72%	31,722	54.30%	12,189	20.87%	17,586	30.11%
Arts and Sciences	177,588	18,059	195,647	165,135	84.40%	75,480	38.58%	41,727	21.33%	52,667	26.92%
Broadcast Services	0	37,922	37,922	37,369	98.54%	13,920	36.71%	4,488	11.83%	6,732	17.75%
Built Environments	9,442	1,617	11,059	9,838	88.96%	5,144	46.51%	2,511	22.71%	4,271	38.62%
Business School	46,174	3,703	49,877	42,171	84.55%	21,442	42.99%	13,282	26.63%	21,043	42.19%
Dentistry	5,061	1,491	6,552	6,088	92.92%	3,915	59.75%	1,692	25.82%	2,007	30.63%
Education	25,366	2,321	27,687	21,309	76.96%	11,368	41.06%	3,765	13.60%	8,014	28.94%
Engineering	40,816	3,937	44,753	37,052	82.79%	18,572	41.50%	9,786	21.87%	17,017	38.02%
Environment	0	31	31	31	100.00%	24	77.42%	16	51.61%	13	41.94%
Evans School of Public Affairs	2,705	574	3,279	3,069	93.60%	1,838	56.05%	1,439	43.89%	1,808	55.14%
Forest Resources	5,638	1,596	7,234	6,192	85.60%	3,511	48.53%	1,533	21.19%	2,693	37.23%
Graduate School	1,944	1,237	3,181	3,015	94.78%	2,006	63.06%	1,401	44.04%	1,510	47.47%
Information School	5,682	395	6,077	5,049	83.08%	3,167	52.11%	1,507	24.80%	2,490	40.97%
Intercollegiate Athletics	0	8,634	8,634	8,495	98.39%	6,757	78.26%	3,632	42.07%	3,536	40.95%
Minority Affairs	0	872	872	856	98.17%	659	75.57%	421	48.28%	494	56.65%
Law	8,793	1,643	10,436	9,589	91.88%	5,139	49.24%	4,048	38.79%	4,711	45.14%
Libraries	0	10,691	10,691	10,562	98.79%	9,010	84.28%	1,758	16.44%	2,013	18.83%
Nursing	10,742	1,410	12,152	10,089	83.02%	5,667	46.63%	2,533	20.84%	4,761	39.18%
Ocean and Fishery Sciences	4,911	819	5,730	4,885	85.25%	2,550	44.50%	1,267	22.11%	2,275	39.70%
Pharmacy	4,171	789	4,960	4,321	87.12%	2,480	50.00%	1,269	25.58%	2,233	45.02%
President's Funds	0	4,050	4,050	3,984	98.37%	3,214	79.36%	1,330	32.84%	2,186	53.98%
Public Health	5,099	819	5,918	5,417	91.53%	3,016	50.96%	2,248	37.99%	2,767	46.76%
Social Work	7,779	832	8,611	7,385	85.76%	3,525	40.94%	1,625	18.87%	2,952	34.28%
Student Affairs	0	9,096	9,096	8,969	98.60%	7,071	77.74%	3,233	35.54%	4,201	46.19%
Undergraduate Academic Affairs	0	986	986	962	97.57%	735	74.54%	420	42.60%	407	41.28%
University Press	0	806	806	774	96.03%	554	68.73%	256	31.76%	296	36.72%
UW Alumni Association	0	40,532	40,532	39,814	98.23%	26,260	64.79%	16,783	41.41%	16,625	41.02%
UW Bothell	7,381	849	8,230	7,742	94.07%	3,918	47.61%	2,551	31.00%	1,446	17.57%
UW Tacoma	8,467	871	9,338	8,777	93.99%	4,454	47.70%	2,474	26.49%	1,365	14.62%
Other University Support	849	7,574	8,423	8,119	96.39%	6,116	72.61%	3,516	41.74%	2,062	24.48%
Unspecified School	16,827	0	16,827	11,819	70.24%	6,583	39.12%	1,787	10.62%	3,768	22.39%
No Degree\Gift Affiliation	0	257,648	257,648	234,380	90.97%	144,394	56.04%	22,242	8.63%	47,404	18.40%
Total	386,501	365,214	751,715	659,203	87.69%	353,398	47.01%	118,955	15.82%	184,690	24.57%

Database Trends

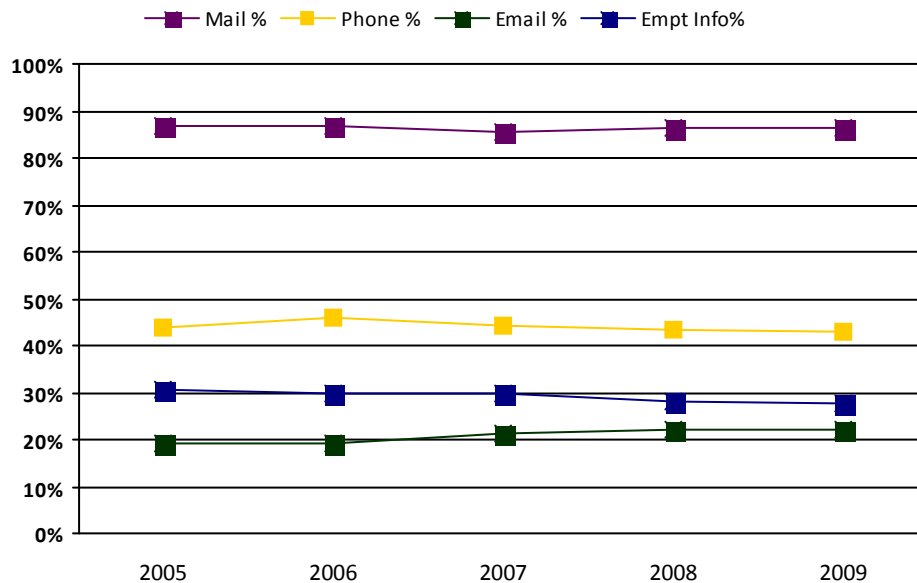

Source: University Advancement, Information Management Report # devrpts_s09032

REPORT OF CONTRIBUTIONS, UNIVERSITY OF WASHINGTON February 2009

All Areas

VII. STANDING COMMITTEES

B. Finance, Audit and Facilities Committee

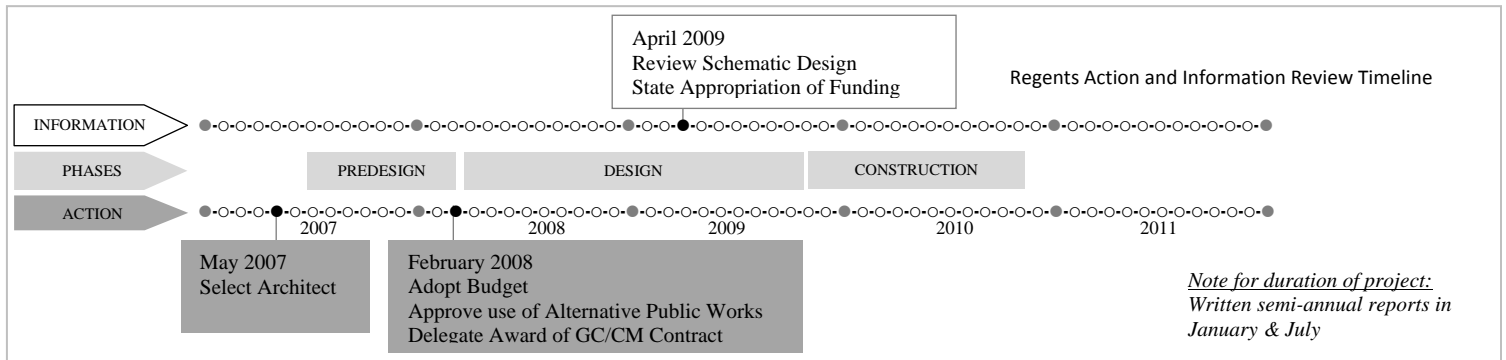
Foster Business School Phase 2 (Balmer) – Review Schematic DesignINFORMATION:

The schematic design phase of the project has been completed. This presentation is for information only.

PROJECT DESCRIPTION:

This project will replace the existing Balmer Hall and will develop a second new facility for the Michael G. Foster School of Business, primarily housing undergraduate classrooms. The current program also includes an observation lab; student organization offices; undergraduate, MBA, and executive education program offices; specialized program offices with support spaces; and a multipurpose/dining room and catering kitchen. Foster Library book stack space currently located in the Balmer basement will be rebuilt in the new building. A loading dock facility will be provided to serve the entire Business School complex.

PREVIOUS ACTIONS:

At the May 2007 Board of Regents meeting, the President was delegated authority to award design contracts to LMN Architects for the Foster Business School Phase 2. At the February 2008 Board of Regents meeting, the project budget of \$46.8M was established; the use of alternative public works utilizing the General Contractor/Construction Manager (GC/CM) method of contracting was approved; and the President was delegated authority to award a construction contract, subject to no significant change in the scope, the forecast cost being within 10% of the budget and funding being in place.

VII. STANDING COMMITTEES

B. Finance, Audit and Facilities Committee

Foster Business School Phase 2 (Balmer) - Review Schematic Design (continued p. 2)

SCOPE OF THE PROJECT:

The current scheme will provide approximately 59,940 gross square feet at an expected project cost of \$46.8 million. This project's construction will begin when the first phase privately-funded, PACCAR Hall is completed. This building connects and functions with PACCAR Hall and is architecturally similar in character. The project is located between McKenzie Hall and the Bank of America Executive Education Center which will comprise the rest of the Business School complex, but will not receive any alterations under either of the two existing projects. In accordance with the requirements of the state of Washington, the project will be designed to achieve Leadership in Energy and Environmental Design (LEED) Silver certification.

SCHEDULE:

Architect Selection	May 2007
Predesign	July 2007 to December 2007
Design	November 2008 to June 2010
Construction Permit	July 2009 to October 2010
Construction	October 2010 to July 2012
Occupancy	September 2012

CURRENT PROJECT STATUS:

The project has completed the Schematic Design Phase and Design Development is beginning. The Architectural Commission approved, with comments, the Schematic Design at their March 2009 meeting. The GC/CM contractor was selected from twelve firms that submitted for consideration. Sellen Construction Co. was the highest scoring firm and the University is executing a Pre-Construction agreement. The Schematic Design cost estimates were prepared by the architect and GC/CM will prepare a check estimate once they are under contract.

SIGNIFICANT RISKS OR OPPORTUNITIES:

Challenges include fully achieving the desired program and solving complex infrastructure requirements at this campus location. Construction staging space will be difficult to provide, and circulation and access to buildings around the site will be complex.

VII. STANDING COMMITTEES

B. Finance, Audit and Facilities Committee

Foster Business School Phase 2 (Balmer) - Review Schematic Design (continued p. 3)

The Architectural Commission agreed that an opportunity exists to improve the courtyard making it an inviting meeting place for collaboration, communication and team building. They also recommended developing the north courtyard as a more serene, less formal meeting place. Currently, very little design effort has gone into developing the north courtyard because funding to modify this area is not currently in the predesign budget. The Commission nevertheless wanted to bring the University's attention to the priority of a complete landscape design (including the north courtyard) for this site appropriate to the investment of this architecture.

The State previously approved the \$4,000,000 design funding for the 2007-2009 Biennium and will need to re-appropriate \$3,000,000 of design funding and approve a construction funding amount of \$42,800,000 in the 2009-2011 budget.

Attachment

Schematic Presentation

UW FOSTER SCHOOL OF BUSINESS
BUSINESS SCHOOL PHASE 2 (BALMER HALL)

VIEW FROM NE



F-3.1/204-09
4/16/09



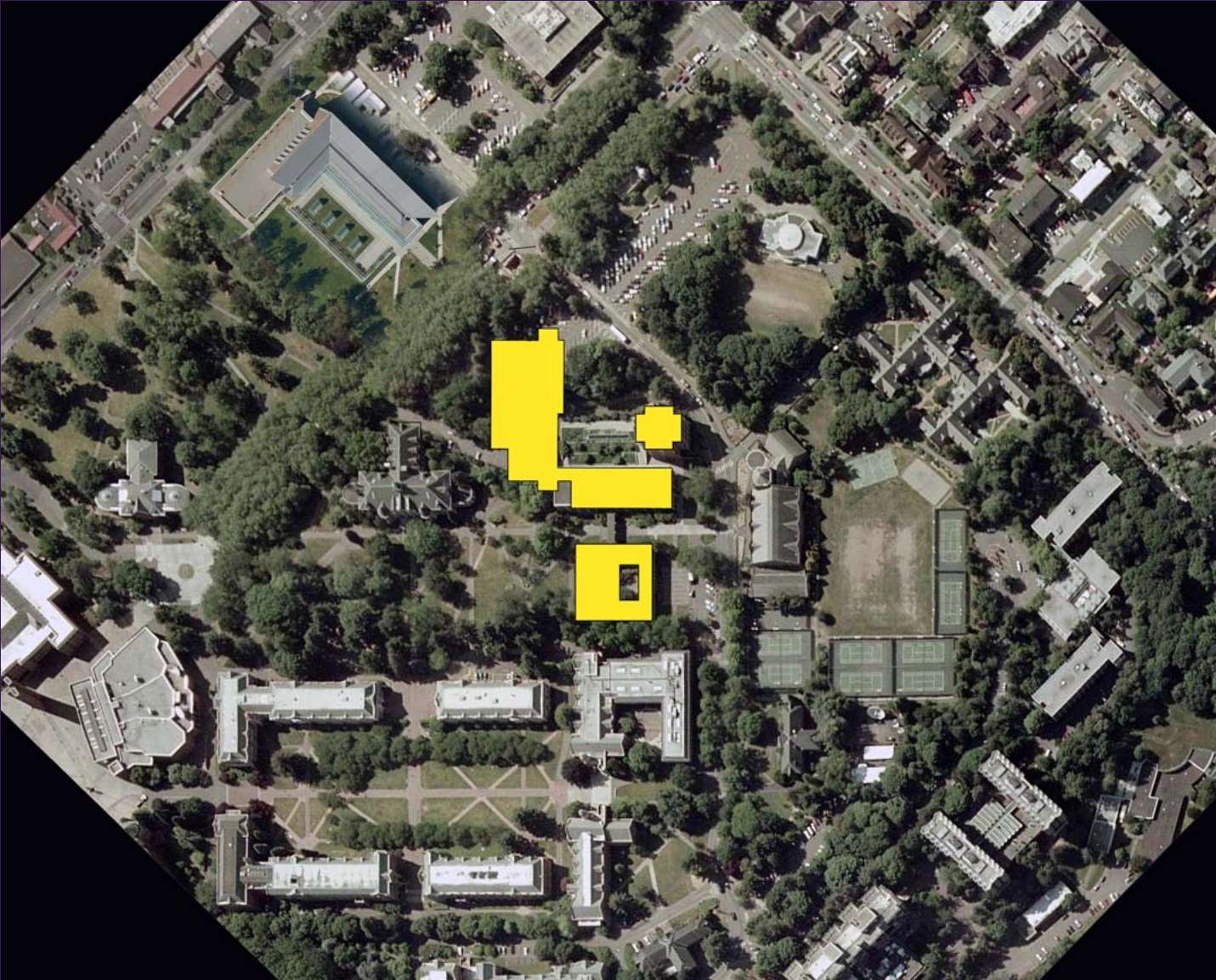



Phase 1+2 Floor Plans



Phase 1+2 Floor Plans

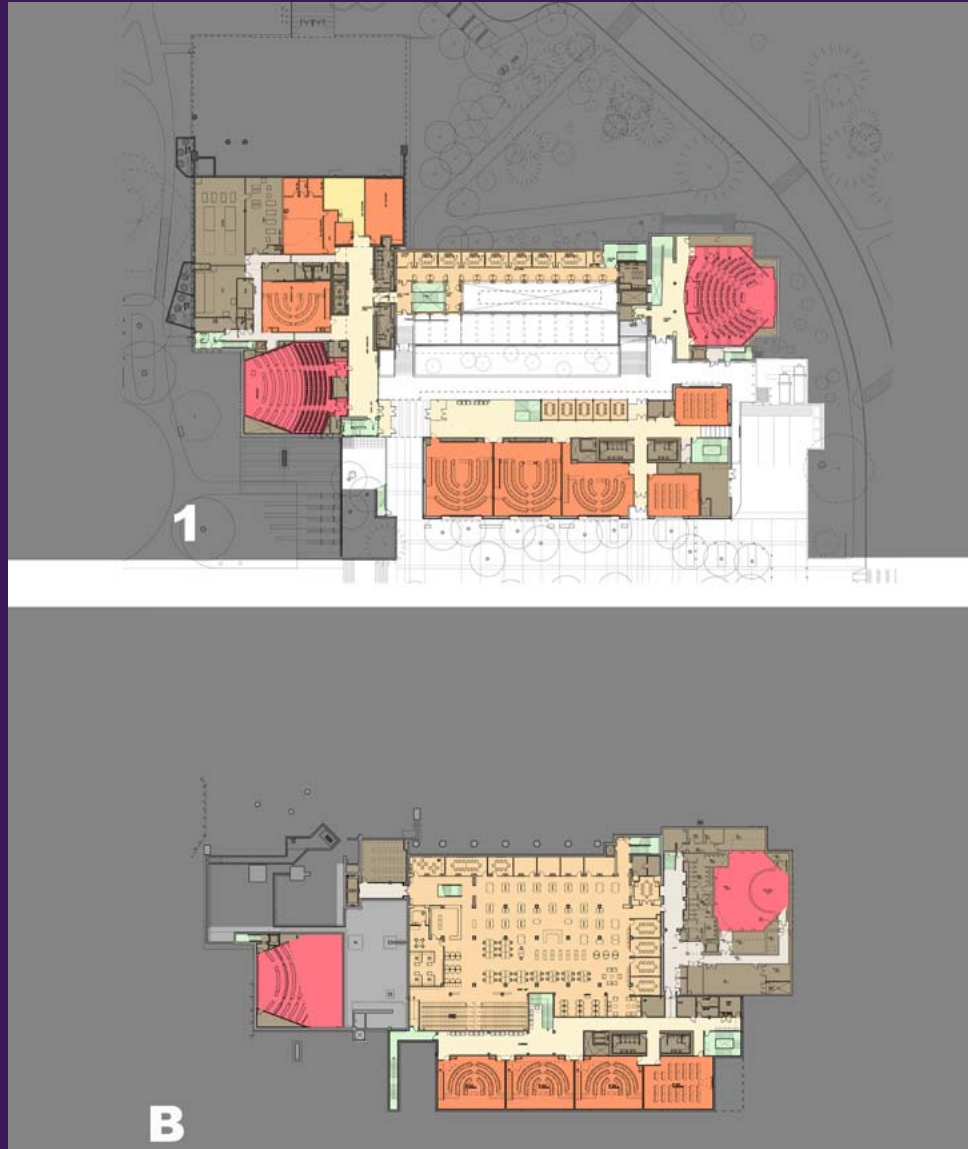

Phase 1+2 Floor Plans

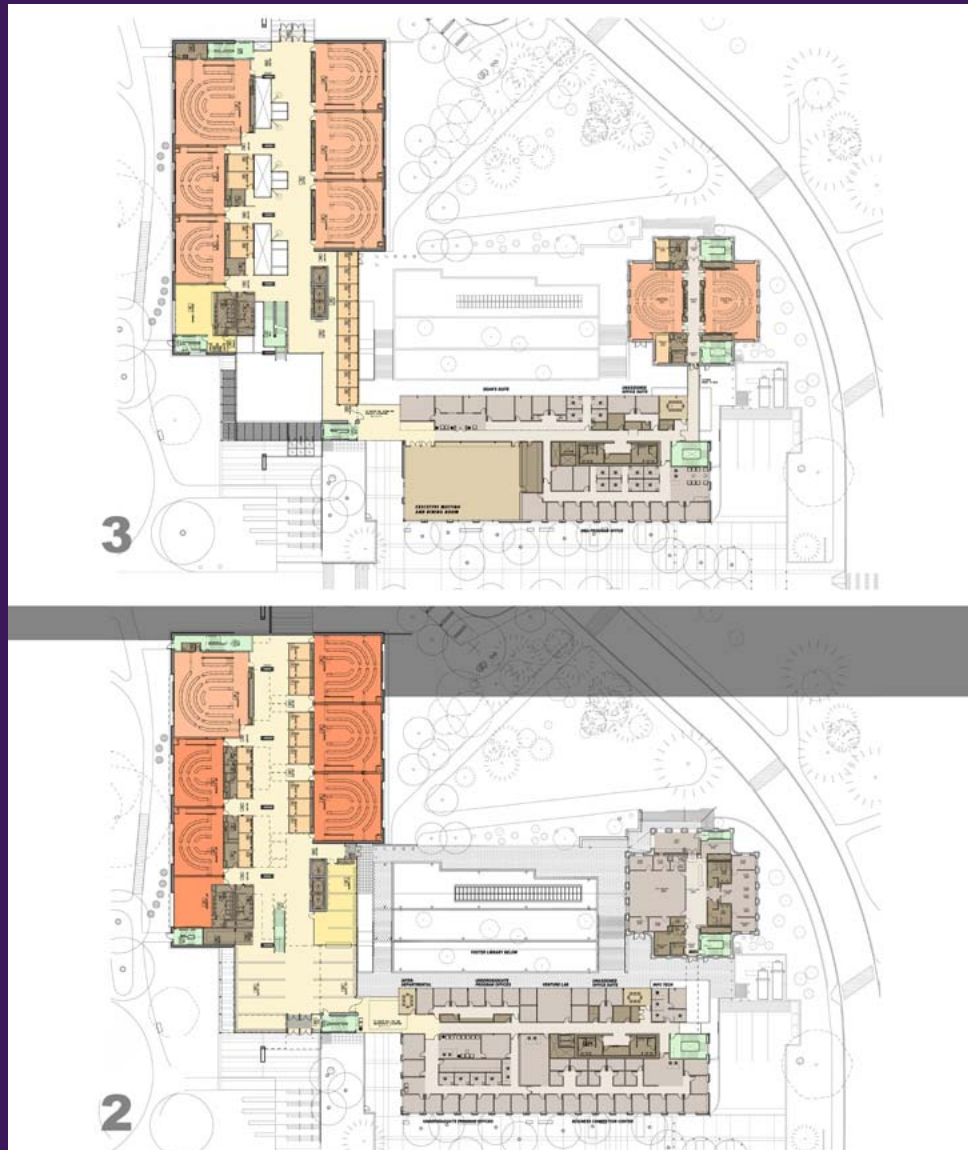

UW FOSTER SCHOOL OF BUSINESS
BUSINESS SCHOOL PHASE 2 (BALMER HALL)

VIEW FROM SE



UW FOSTER SCHOOL OF BUSINESS
BUSINESS SCHOOL PHASE 2 (BALMER HALL)

VIEW FROM SW





VII. STANDING COMMITTEE

B. Finance, Audit and Facilities Committee

Capital Projects Office Semi-Annual Status Report

This will be a PowerPoint presentation at the meeting.



Capital Projects Office Semi-Annual Status Report

October 2008 - March 2009

TRIR Calendar Year

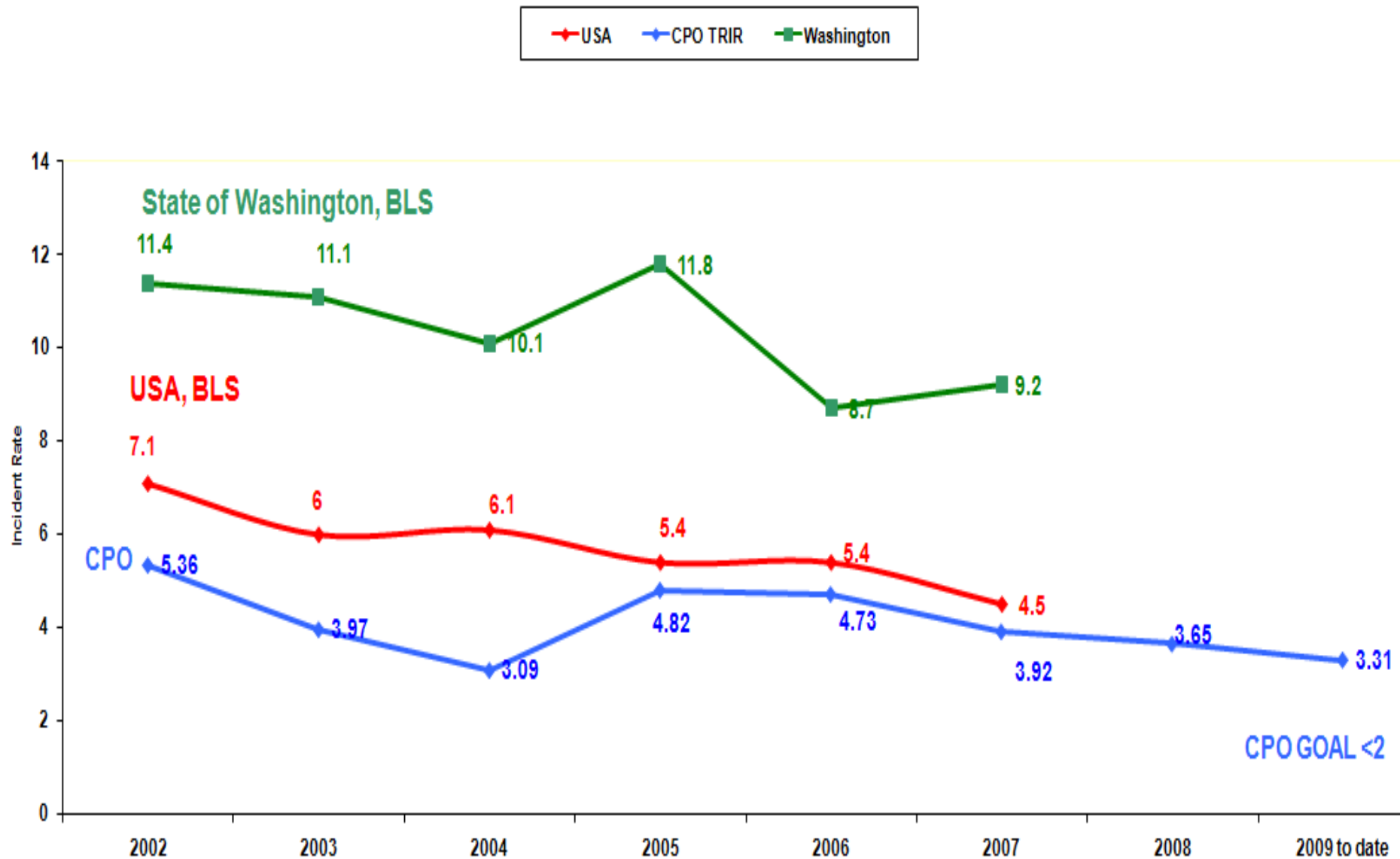

CPO GOAL <2

Construction Cost Index Comparison

	Rider Levett Bucknall Seattle	ENR
July 2001	100.11	100.14
October 2001	100.20	100.22
January 2002	100.33	100.65
April 2002	100.45	100.87
July 2002	100.45	101.09
October 2002	99.52	101.30
January 2003	99.58	101.52
April 2003	99.34	102.50
July 2003	99.12	103.47
October 2003	99.42	104.48
January 2004	99.65	105.48
April 2004	102.12	107.84
July 2004	105.37	109.04
October 2004	105.80	113.81
January 2005	107.66	114.19
April 2005	107.88	114.95
July 2005	108.56	115.22
October 2005	111.36	117.12
January 2006	114.65	118.64
April 2006	118.44	118.24
July 2006	122.95	118.86
October 2006	126.51	120.79
January 2007	130.61	120.68
April 2007	135.45	120.76
July 2007	138.43	125.05
October 2007	143.10	124.69
January 2008	146.77	124.56
April 2008	147.88	125.07
July 2008	150.90	128.55
October 2008	151.78	133.16
January 2009	145.78	130.83
April 2009	134.29	130.26

Base index April 2001 = 100
Recalibrated April 2005

— Rider's Seattle Construction Cost Index
— ENR National Construction Cost Index

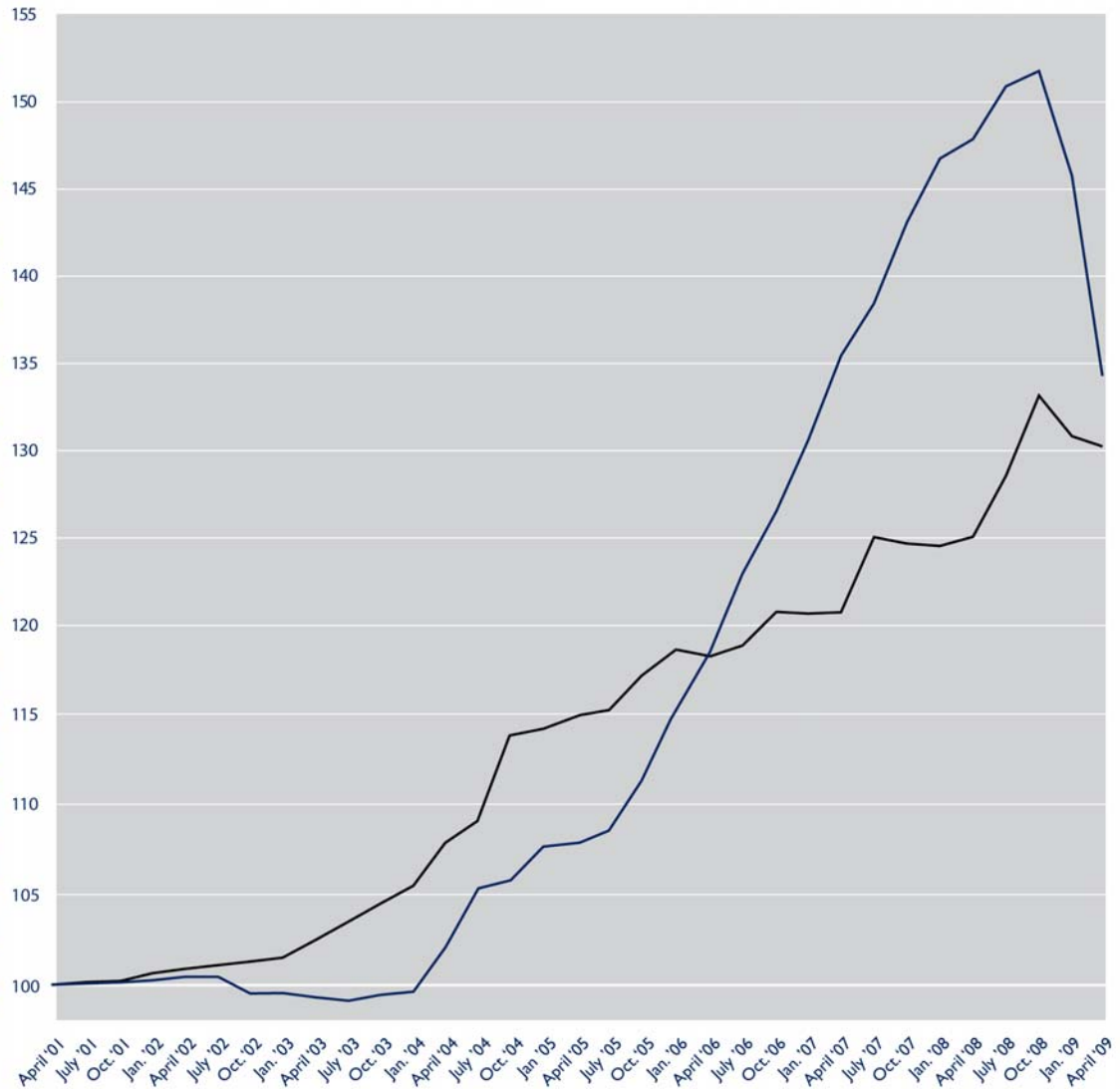

Consulting Contracts Negotiations

- A/E Contracts – Major Projects
- Term Consulting Agreements
- Haz Mat Term Agreement
- Job Order Contracting

Emerging Projects

- Long House
- Burke Museum
- Environmental-Bio Sciences



Other Projects

- Ocean Observatories
- Sound Transit



OOI Components

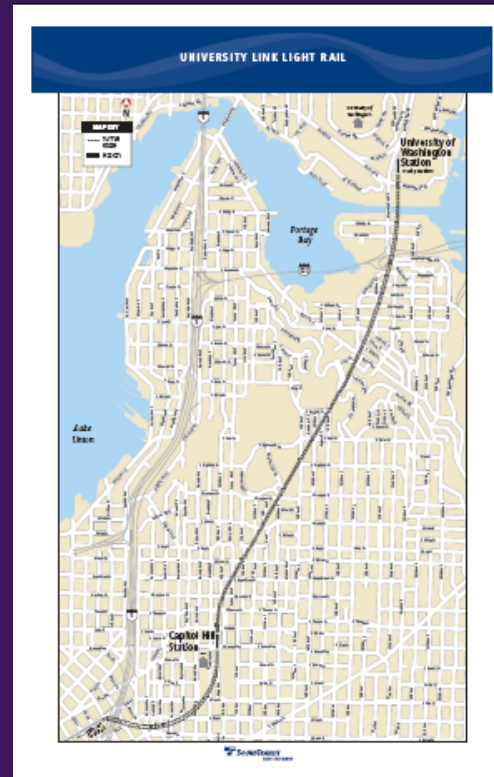

Major Projects Closed

	<u>Budget/F'cst \$M</u>	<u>Use Date / F'cst</u>
Guggenheim Hall	28.3 / 27.8	9-07 / 9-07



Projects Under \$5 Million Closed

Closed Special Projects - 99
10/2008 - 3/2009

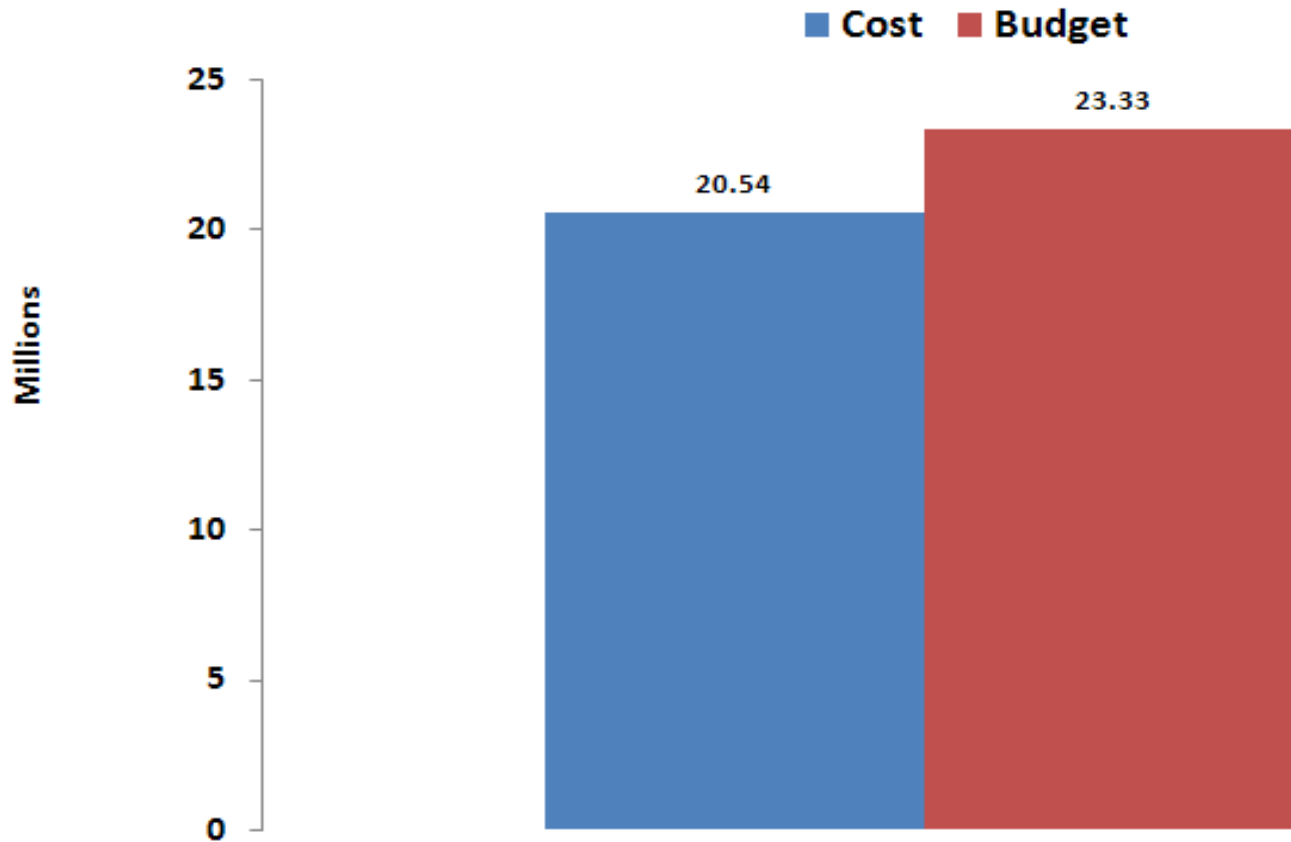

Number of Project Contracts Issued October 2008 – March 2009

	<u>W/MBE</u>	<u>Total</u>
Designers/Consultants	24 (15%)	160
Contractors	27 (48%)	56

Benjamin D. Hall Interdisciplinary Research Building



Architecture Hall



Wm. H. Philip Hall

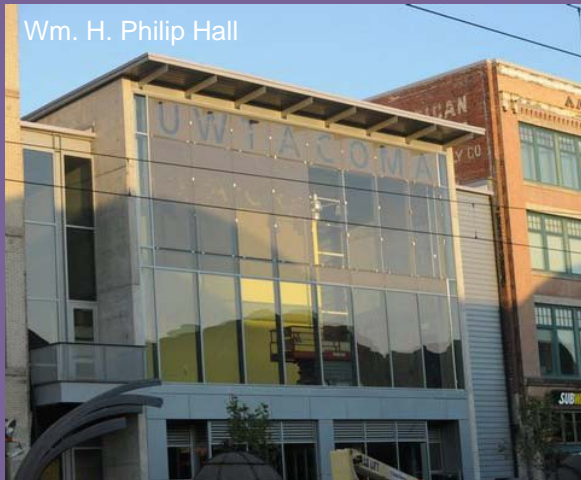

Floyd & Delores Jones Playhouse



Major Projects in Closeout

	<u>Budget/F'cst \$M</u>	<u>Use Date / F'cst</u>
Architecture Hall	24.5 / 23.8	9-07 / 9-07
Benjamin D. Hall Bldg.	29.9 / 29.4	9-05 / 3-06
Clark Hall	18.1 / 17.9	3-09 / 3-09
Harborview Bond	221.1 / 221.1	4-08 / 9-09
Mag HSC H-Wing	43 / 40	10-08 / 10-09
Playhouse	9.9 / 10.7	9-08 / 11-08
UWT Philip Hall	12.1 / 11.6	9-09 / 9-09
W. Campus Garage*	17.9 / 11.6	9-09 / 3-09

* 321 net new stalls - \$36K / stall

Major Projects in Bid/Construction

	<u>Budget/F'cst \$M</u>	<u>Use Date / F'cst</u>
Savery Hall	61.2 / 60.1	9-09 / 9-09
Tower Data Center	32.5 / 31.2	12-09 / 9-09
Business Phase 1	95 / 94.7	9-10 / 9-10
Radiation Oncology	5.3 / 5.3	6-09 / 6-09
HSC 6 th Floor-RR Wing	28.7 / 26.2	1-10 4-10 / 5-10
Ben Hall iAMT	6.6 / 6.4	9-09 / 9-09
Ben Hall APL	8.7 / 7.6	10-09 / 10-09
Wash. Dental Bldg.	19.8 / 19.8	9-10 / 9-10

Major Projects in Design

	<u>Budget/F'cst \$M</u>	<u>Use Date / F'cst</u>
UWMC Expansion	165 / 165	9-11 / 9/11
J-Wing Microbio.	23.5 / 21.0	3-11 / 3-11
Housing Ph. 1	TDB / 158	TBD / 9-11
Hall Health	1.03 / 9.7	TBD / 1-11
HUB Renovation	3 / 140	TBD / 1-13
Ethnic Cultural Center	.85 / 15	TBD / 9-11

UWMC Expansion

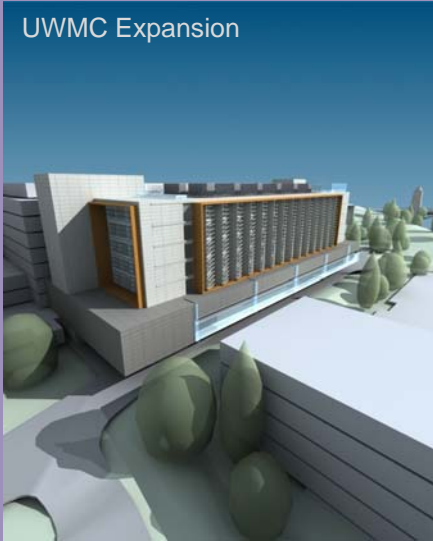

UW Tower Data



HUB Expansion & Renovation



Washington Dental Building



West Campus Parking Garage



Major Projects in Design

	<u>Budget/F'cst \$M</u>	<u>Use Date / F'cst</u>
Denny Hall	57.0 / 57.0	9-11 / 9-11
Lewis Hall	25.1 / 25.1	1-11 / 1-11
Molecular Eng.	78.5 / 78.5	1-12 / 1-12
UWT Phase 3	60.2 / 60.2	9-11 / 9-11
Bus. School 2	46.8 / 46.8	9-12 / 9-12
Husky Stadium	TBD / 300	TBD / 7-11

VII. STANDING COMMITTEES

B. Finance, Audit and Facilities Committee

2008 Internal Audit Results and
Report of Planned Audit Activities for 2009

Attachments: Report of Internal Audit Results 2008
 Report of Planned Internal Audit Activities 2009



Report of Internal Audit Results 2008



Finance, Audit and Facilities Committee
Board of Regents

Department of Audits
University of Washington

April 2009

Table of Contents

Executive Summary	1
Work Accomplished.....	2
Results of Audits	4
Audit Hours by Type of Audit – Budget and Actual.....	6
Implementation of Audit Recommendations	7

Appendix

Internal Audit Charter	1
Audit Coverage Overview	2
Contract Auditors - 2008	3
External Auditors - 2008	4

Executive Summary – Report on Results

Internal Audit engages in three primary activities – audits, investigations and advisory services. Our focus is to assist schools and colleges in understanding financial, operational, strategic and compliance risks and exposures. Rather than duplicate the financial and compliance auditing performed by KPMG and the State Auditor’s Office, Internal Audit concentrates on departmental control systems and processes.

Audits

In 2008, we completed ten planned audits in the following high risk areas:

- Cash handling
- Faculty effort certification
- Grants and contracts management
- Information systems security and governance
- Intercollegiate Athletics
- Medical Center service capture
- Payroll and Human Resources
- Rate setting and billing

Two additional audits are substantially complete and seven more are in progress.

Overall, we found departments generally had good control systems in place related to financial management, operations and federal compliance. Exceptions resulted primarily from the lack of sufficient management oversight rather than problems systemic at the University level.

Our information system audits focused primarily on the security of data stored in decentralized, department-owned systems. We found departments need to strengthen controls related to user access, data integrity and security, and risk assessments.

Medical Centers

New staff was hired to round out the audit team in 2008 and provide needed expertise. Three audits were completed during the year and another one is in process.

Fraud Reporting Hotline

Implementation of a University-wide anonymous fraud reporting hotline was discussed with key management personnel throughout the University and presentations were made by peer universities on their hotlines. Work is underway to develop the guiding principles and operating procedures for the hotline.

Enterprise Risk Management

Internal Audit continues to participate in the University’s process to identify, assess and mitigate enterprise-wide risks.

Work Accomplished

Scheduled Audits *

Completed:

Cash Handling

- College of Forest Resources – UW Botanic Gardens
- Undergraduate Academic Affairs – Classroom Support Services

Faculty Effort Certification

Department of Genome Sciences – School of Medicine

Information Technology Services

Intercollegiate Athletics

Medical Centers' Payroll and Human Resources

Department of Otolaryngology – School of Medicine

UWMC Radiology Service Capture

Washington National Primate Research Center – Health Sciences

Audit Follow-ups (32)

In Progress:

Bothell Campus – Chancellor's Office

Department of Global Health – International Training and Education Center on HIV

Educational Outreach (substantially completed)

Grants and Contracts – Subrecipient Monitoring

Medical Centers' Laboratory Medicine Charge Capture

School of Nursing

School of Medicine-Laboratory Medicine

Student Database

Student Publications (substantially completed)

Management Requests

Foster School of Business (outside work reporting)

Intercollegiate Athletics (ticket certification)

International Programs and Exchanges (fiscal operations) *

Advisory Services

Internal Control Consultations (170)

* See page 4 and 5 for results of 2008 Audits

Work Accomplished (continued)

Special Investigations

Fraud (3)
Ethics (7)
Regulatory (2)
Operations (6)

Training Provided

Grants (5)
Internal Controls and Fraud Prevention (4)
State Ethics Law (5)
Work & Leave Records Maintenance (4)

UW Committees

- Campus Security Advisory Committee
- Compliance, Operations & Finance Council
- Data Management Users Group
- Global Support Committee
- President's Advisory Council on Enterprise Risk Management
- Privacy Assurance & Systems Security Council
- Tax Strategy Team

Memberships

State Committees

- Higher Education Interinstitutional Internal Auditors

Professional Organizations

- Agora (Information Systems Security)
- American Institute of Certified Public Accountants
- Association of Certified Fraud Examiners
- Association of College & University Auditors
- Association of Healthcare Internal Auditors
- Information Systems Audit and Control Association
- Institute of Internal Auditors
- Pacific Northwest Chapter of Certified Fraud Examiners
- Washington State Society of CPAs

Results of Audits

In 2008, the Department of Audits continued to emphasize the importance of strong systems of internal control.

Overall, we found that internal controls are sufficient to ensure compliance with applicable regulations and policies, and to ensure that business objectives are achieved. We found no flagrant deficiencies in the course of these scheduled audits. Audit exceptions resulted primarily from lapses in management oversight and not from systemic problems at the University level.

Cash Handling

We reviewed two departments as part of our University-wide audit of cash handling. We recommended that controls be strengthened for depositing cash receipts timely and separating conflicting cash handling functions.

Faculty Effort Certification

We reviewed controls over the certification of faculty effort on sponsored programs. We found the University had good controls in place to ensure effort reports are accurate, certified timely and available for review. We recommended strengthening controls over reporting salary transfers and comparison of actual to committed effort.

Department of Genome Sciences

We evaluated the system of internal controls over grants fiscal management, payroll, purchasing, procurement cards, travel, revolving funds, and operations of a self-sustaining unit. Overall we found the department had good internal controls. We recommended principal investigators review and approve their monthly budget activity.

Information Technology Services

We reviewed IT Services strategic planning process, organization structure, and project intake and oversight processes. We recommended enhancing communication with customers regarding ITS roles, responsibilities and processes and strengthening project tracking for mid-size projects to better manage resources and account for budget to actual costs and efforts.

Intercollegiate Athletics

We reviewed internal controls over sports camps and clinics, student employment, self-reported violations, rules education, coaching staff limits and contracts, student-athlete eligibility, and cash handling. We recommended strengthening controls in the areas of sports camps and clinics, student employment, volunteer coach appointments, and cash handling.

Results of Audits (continued)

International Programs and Exchanges

We reviewed controls relating to the use and management of operational and program budgets, and the awarding of scholarships and tuition waivers. We recommended strengthening controls in the areas of collection of fees, allocation of costs, financial management and monitoring, and the awarding of scholarships and tuition waivers.

Medical Centers' Payroll and Human Resources

We reviewed internal controls over time collection, application access security, management of leave and overtime, employee payroll changes, and accuracy of gross pay. We recommended strengthening controls in the areas of timesheet approval, user access, leave management, records retention and separation of employees.

Department of Otolaryngology

We reviewed controls over grants and contracts, gifts and endowments, human resources, payroll, purchasing, information technology (IT) management and entity administration. We recommended strengthening controls in the areas of grant and contract certification reports, Online Work Leave System, procurement card, revolving fund, IT assets management, IT risk assessments and system certifications and training. We also recommended the department clarify its authority and responsibility over the Virginia Merrill Bloedel Hearing Research Center.

UWMC Radiology – Service Capture

We reviewed internal controls over the service capture process and the security, integrity and availability of data. We recommended strengthening controls related to accounting for transaction numbers, receipt and retention of physician orders, user access management and performance of annual IT risk assessments.

Washington National Primate Research Center

We reviewed internal controls over rate setting, billing and revenue collection, IT security, systems access, data management and software project management. We recommended strengthening controls for billing, IT security, system access, data management and software project management.

Audit Hours by Type of Audit - Budget and Actual

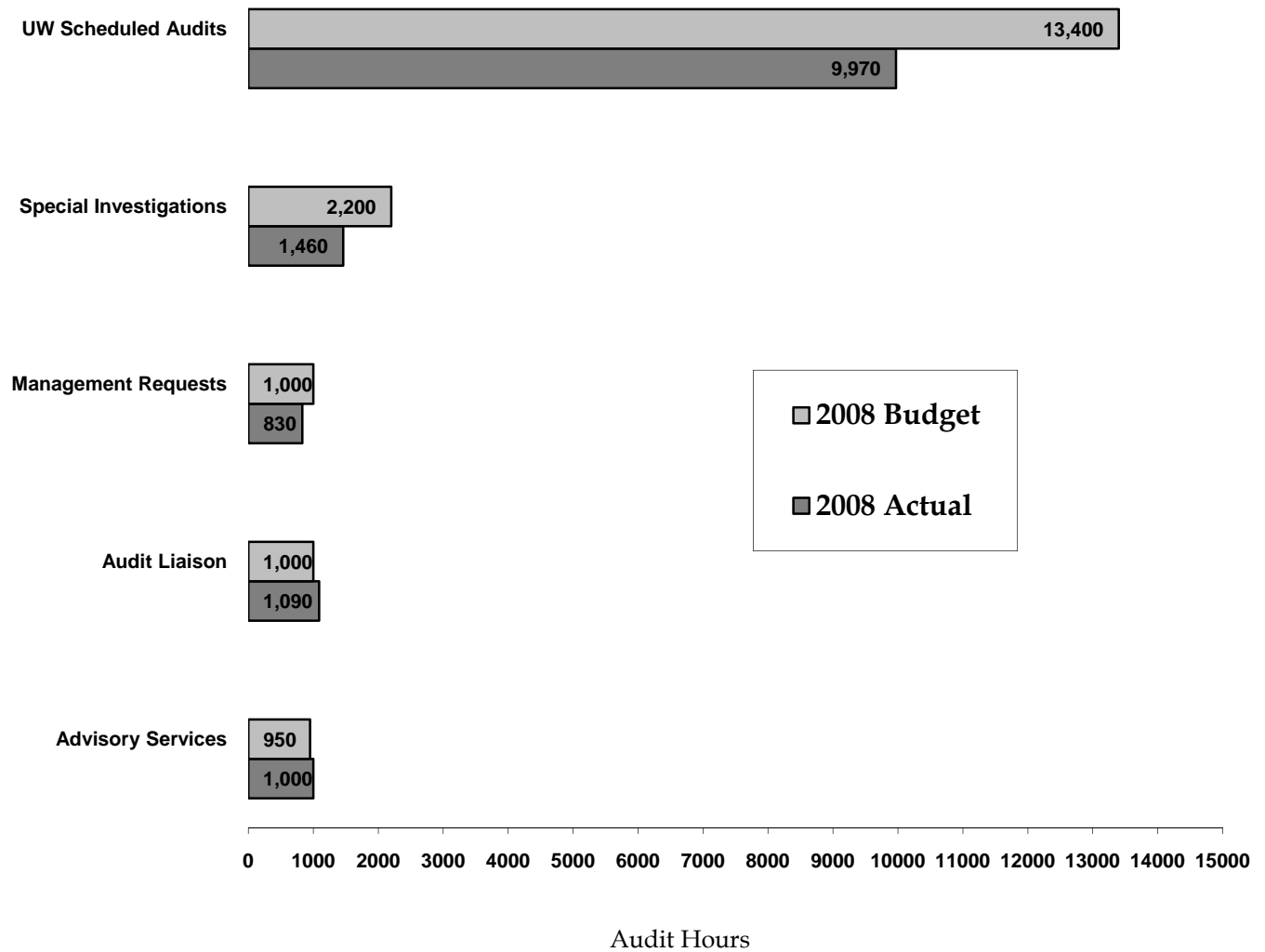

Actual hours spent on scheduled audits was under budget due to staff vacancies experienced during the year and time required for hiring and training new staff.

Actual hours spent on special investigations was less than anticipated.

Implementation of Audit Recommendations

Internal Audit conducts follow-up reviews to determine whether audit recommendations agreed to by management have been implemented. Follow-up reviews generally occur six months after an audit is completed.

Percentage of Recommendations Implemented for the Years 2004-2008

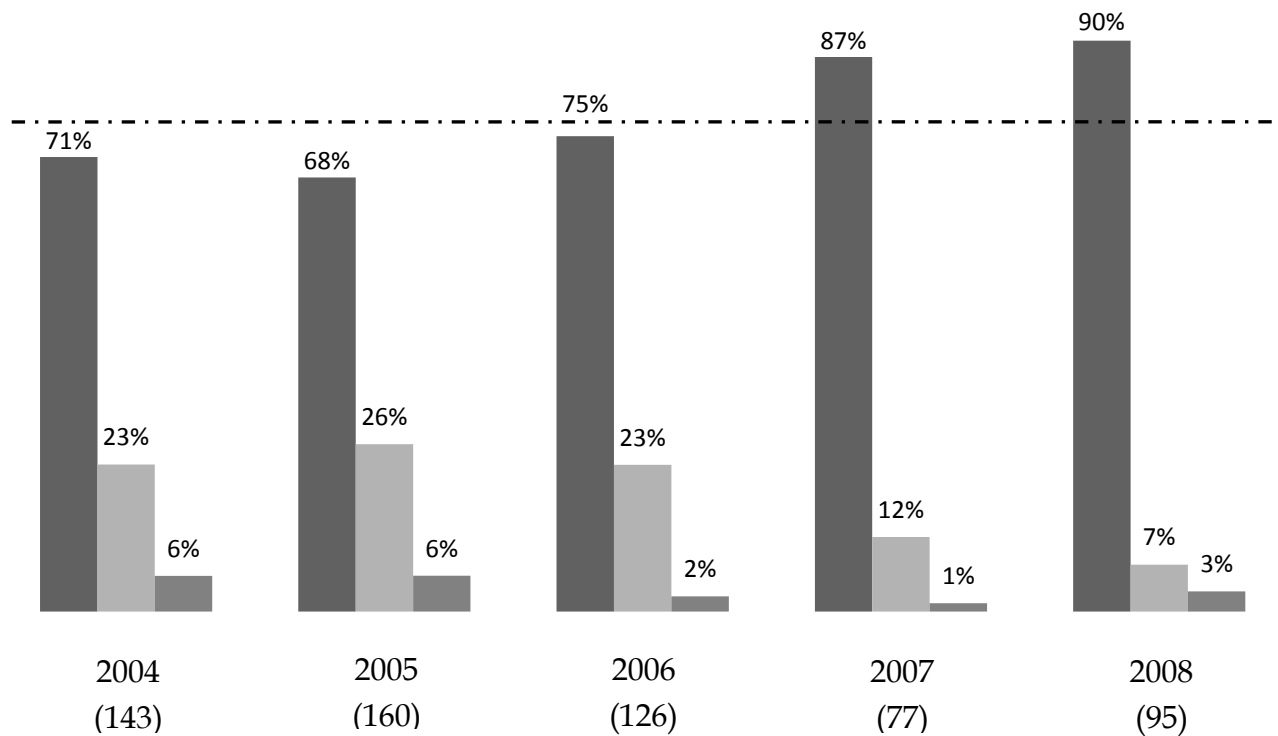

Total Audit Recommendations by Year

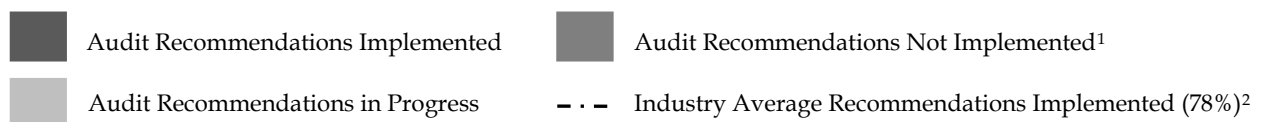

¹ Management planned to implement the audit recommendations but had not done so at the time of our follow-up reviews. Audit recommendations had not been implemented because of staffing limitations and turnover, other higher priorities or the complexities of implementing solutions.

² Source: The 1999 Analytical Benchmarking for Auditors in the College and University Sector (ABACUS).

Internal Audit Charter

Mission -The mission of Internal Audit is to assist the Board of Regents and University management in the discharge of their oversight, management and operating responsibilities. This is achieved by providing independent assurance, consulting and education services to the University community. Our services add value by improving the control, risk management and governance processes to help the University achieve its business objectives.

Authority - The Department of Audits functions under the authority of the Finance, Audit and Facilities Committee of the Board of Regents of the University of Washington.

The Department of Audits is authorized to have full, free, and unrestricted access to information including records, computer files, property, and personnel of the University. Internal Audit is free to review and evaluate all policies, procedures and practices of any University activity, program or function.

In performing the audit function, the Department of Audits has no direct responsibility for, or authority over any of the activities reviewed. Therefore, the internal audit review and appraisal process does not in any way relieve other persons in the organization of the responsibilities assigned to them.

Scope - The scope of the internal audit activity encompasses the examination and evaluations of the adequacy and effectiveness of the University's system of internal control and the quality of the performance in carrying out assigned responsibilities including appropriate training and consulting assistance. Internal auditors are concerned with any phase of University activity in which they may be of service to management. This involves going beyond the accounting records to obtain a full understanding of operations under review.

Independence - To permit the rendering of impartial and unbiased judgment essential to the proper conduct of audits, internal auditors will be independent of the activities they audit. This independence is achieved through organizational status and objectivity.

Organizational Status: The Executive Director of Audits is responsible to the Treasurer, Board of Regents, whose scope of responsibility and authority assures that audit findings and recommendations will be afforded adequate consideration and the effectiveness of action will be reviewed at an appropriate level. The Executive Director of Audits has direct access to both the President and the Board of Regents, and may take matters to them that are believed to be of sufficient magnitude and importance to require their immediate attention.

Objectivity: Because objectivity is essential to the audit function, an internal auditor does not develop and install procedures, prepare records, or engage in any other activity which the auditor would normally review and appraise and which could reasonably be construed to compromise the auditor's independence. The auditor's objectivity is not adversely affected, however, by determining or recommending standards of control to be adopted in the development of systems and procedures under review.

Responsibility - The internal audit staff has a responsibility to report to University management on the areas examined and to evaluate management's plans or actions to correct reported findings. In addition, the Executive Director of Audits has a responsibility to report at least annually to the Board of Regents Finance, Audit and Facilities Committee and to inform the Board of any significant findings that have not been reasonably addressed by University management.

The Executive Director of Audits will coordinate internal and independent outside audit activities to ensure adequate coverage and minimize duplicate efforts.

Standards - The responsibility of the Department of Audits is to serve the University in a manner that is consistent with the standards established by the internal audit community. At a minimum it shall comply with the relevant professional audit standards and code of conduct of the Institute of Internal Auditors (IIA) and the Association of College and University Auditors (ACUA).

Audit Coverage Overview

As part of the coordinated audit approach adopted in 1990, the Department of Audits works closely with contract auditors and the State Auditor to maximize audit coverage and to avoid duplication of effort. Each audit organization has a specific role:

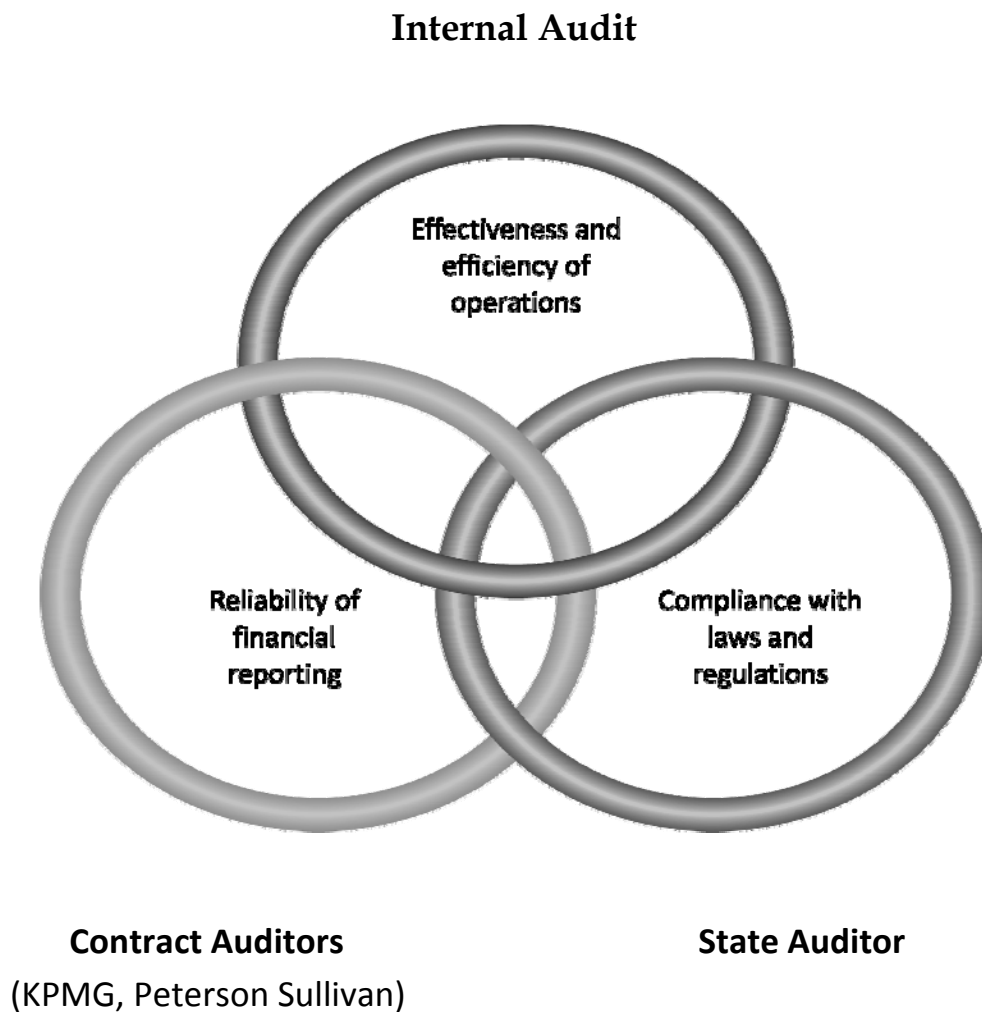

Contract Auditors – 2008

KPMG

Financial Statement audits for:

- University of Washington
- Intercollegiate Athletics
- Parking Services
- UW Medical Center
- UW Medical Center Consolidated Laundry
- Harborview Medical Center
- Association of University Physicians (dba UW Physicians)
- UW Physicians Network

Peterson Sullivan

- Metropolitan Tract Financial Statements
- UNICO Properties – Lease Compliance
- Fairmont Olympic Hotel – Lease compliance
- GVA Kidder Matthews – Operating Agreement (Rainier Tower Sublease)

Financial statement audits for:

- Associated Students of the UW
- Graduate and Professional Student Senate
- Student Publications
- Student Union Facilities
- Housing and Dining System
- Retail and Remote Food Services

External Auditors – 2008

State Auditor's Office

Audit of compliance with state laws and regulations
Audit of federal programs in accordance with the Single Audit Act
Whistleblower and citizen complaint investigations

Federal Agencies

Department of Education

Follow up on State Auditor finding – Office of Minority Affairs
Audit of costs claimed – Rehabilitation Medicine

Department of Health & Human Services Office of Inspector General

Audit of costs claimed – Oceanography
Cash management – Grant and Contract Accounting

Department of Labor

Desk audit of Affirmative Action – Equal Opportunity Office

Defense Contract Audit Agency

Audit of prorated direct cost rate – Applied Physics Laboratory

National Aeronautics and Space Administration Audit and Compliance Office

Desk audit of costs claimed – Earth and Space Sciences

National Institute of Health Office of Biotechnology Activities

Oversight of Recombinant DNA Research – Environmental Health and Safety

National Science Foundation Office of Inspector General

Special investigation of compliance with laws, regulations and conditions pertaining to
NSF awards – Materials Science and Engineering
Desk audit of participant support costs - Computer Science and Engineering

Office of Naval Research

Property control system analysis – Equipment Inventory Office

California Healthcare Foundation

Audit of costs claimed – Pediatrics

King County

Desk audit of systems and controls – Pediatrics, Adolescent Medicine

San Francisco State University

Desk audit of costs claimed – Forest Resources

Sandia National Laboratories

Desk audit of costs claimed – Electrical Engineering, Bioengineering, Mechanical
Engineering, Chemical Engineering, and Chemistry

Singapore Agency for Science, Technology and Research

Desk audit of costs claimed – Bioengineering



Report of Planned Internal Audit Activities 2009



Finance, Audit and Facilities Committee
Board of Regents

Department of Audits
University of Washington

April 2009

Table of Contents

Executive Summary	1
Audit Focus	2
Scheduled Audits	4
Planned Audit Hours	5
Summary of Audit Coverage	6
Appendix	
Risk Assessment Methodology	1
Elements of the Audit Planning Process.....	2

Executive Summary

Internal Audit engages in three primary activities – audits, advisory services, and investigations. Our focus is to actively work with campus schools and colleges, assisting management to address financial risk and exposures. Rather than duplicate the financial and compliance auditing performed by KPMG and the State Auditor's Office, Internal Audit concentrates on departmental control systems and processes. In this way, audit resources are maximized.

Internal Audit's goals for 2009 are:

- Complete the top ten highest risk audits
- Refine the Medical Centers risk assessment process
- Implement a University-wide fraud reporting hotline
- Continue to participate in the development of University-wide enterprise risk management framework

The University of Washington Internal Audit Plan for 2009 is designed to provide comprehensive audit coverage, deploying Internal Audit resources in an effective and efficient manner. As in years past, we will continue to focus on the high risk areas as identified by our risk assessment.

Audit Focus

Cash Handling

Over a billion dollars in cash is received each year at multiple locations throughout the University. We will continue to review controls in high risk cash handling locations to ensure University assets are properly accounted for and adequately protected against misappropriation.

Data Security

The University acquires, generates and maintains significant information to support business operations, education programs and extensive research efforts. In 2009, we plan to review information security controls designed to ensure only authorized persons access University data and information systems. This will include the compliance audit that is required every three years by the Washington Information Services Board (ISB).

Departmental Computing and Networking

University departments often develop and operate specialized computer systems to support their own unique information processing needs. Our focus is to identify critical systems and networks managed at the department level, to evaluate relevant information security and controls and minimize the risk of processing interruptions.

Federal Programs

We anticipate continued federal interest in research and program accountability. The University can be proud of its award-winning grants management program. Internal Audit will continue to identify high risk departments and work with the departmental management to provide reasonable assurance of compliance with applicable regulations.

Health Insurance Portability and Accountability Act (HIPAA)

Compliance with HIPAA is required by federal regulations, and is necessary to ensure the protection of identifiable health information. An established compliance group has oversight responsibilities to ensure adherence to HIPAA requirements throughout the medical centers. We will work with the HIPAA compliance team to evaluate the University's compliance activities to ensure conformance with HIPAA.

Hospital and Clinical Billing

The ability to capture services and bill them in a timely manner is critical to the University's ability to collect revenue from its payers. We will perform a review to evaluate whether controls are sufficient to ensure timely and accurate billing.

Audit Focus (continued)

Internal Control Systems

The University continues to move its central systems away from pre-approval controls toward post audit controls. Internal Audit provides advisory services and training to ensure departments continue to have a sound basis for establishing and monitoring internal control systems. It is more important than ever that departmental management understand the risks and responsibilities associated with operating in a decentralized post audit control environment. As more versatility is delegated to departments, oversight is required to ensure that controls are in place and serve the intended purpose.

Resource demands on departmental general operating funds force departments to make difficult decisions regarding resource allocations. Resource pressures may result in the elimination of critical systems of controls. Without appropriate checks and balances, departments have a higher exposure to financial irregularities and noncompliance with policies and regulations.

Medical Centers Materials Management

Our audit focus will be on controls that ensure inventory is properly accounted for and safeguarded against theft and loss.

Medical Centers Software Change Controls

Critical information system projects are in progress at the Medical Centers. Considerable software maintenance activities are also performed. Effective software change controls are important to ensure the quality and continued processing accuracy of information systems. We will review the controls in place to minimize risks of processing errors introduced by changes in software.

Subrecipient Monitoring

The monitoring of subrecipients of federal funds continues to be scrutinized by federal and state auditors. When the University is awarded federal funds to perform research or other projects, it may choose to subcontract a portion of the work out to other organizations. The University is responsible for monitoring subrecipients to ensure they comply with federal regulations and achieve program objectives. We will review controls to ensure that subrecipient monitoring is performed in accordance with federal regulations.

Scheduled Audits

Bothell Campus – Chancellor’s Office *

Tacoma Campus – Chancellor’s Office

College of Arts & Sciences - Speech & Hearing

School of Dentistry – Billing system

School of Medicine

- Comparative Medicine – Recharge center

- Laboratory Medicine – Grants management and self sustaining activities *

- Metabolism and Endocrinology

- Pathology – Purchasing system

School of Nursing – Grants management and data security *

School of Public Health – International Training and Education Center on HIV – Grants management *

Medical Centers

- HIPAA – Compliance

- Laboratory Medicine – Charge capture *

- Information Technology Services – Change management

- Materials Management

Cash Handling

Educational Outreach *

Facilities – Purchasing and inventory

Grants and Contracts – Subrecipient monitoring *

Intercollegiate Athletics – NCAA compliance and payroll

Student Database – Data security and privacy *

Student Publications *

Systems Development Reviews – Various systems

UW Technology

- Business/ Administration

- Nebula – Data security

- UW Net ID / ASTRA – Data security

- Required compliance review - Washington Information Services Board

Various Departments – Follow-ups

* In progress

Planned Audit Hours

By Category

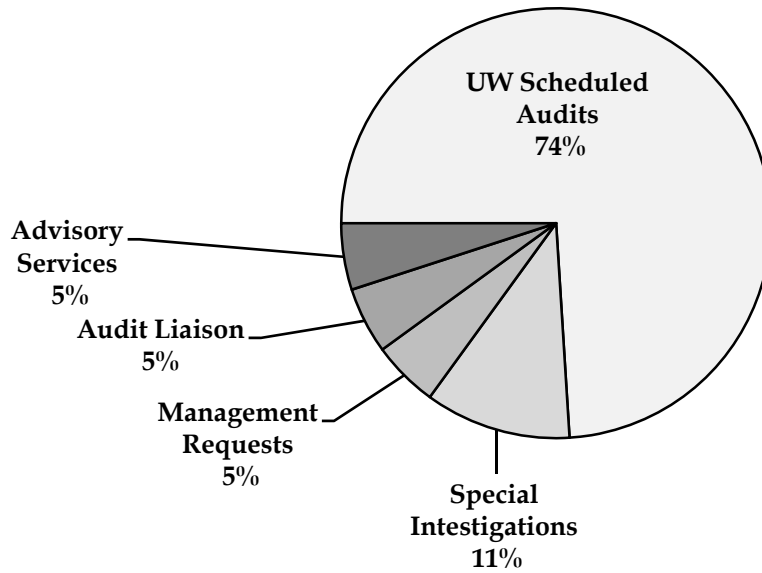

Compared to Prior Year

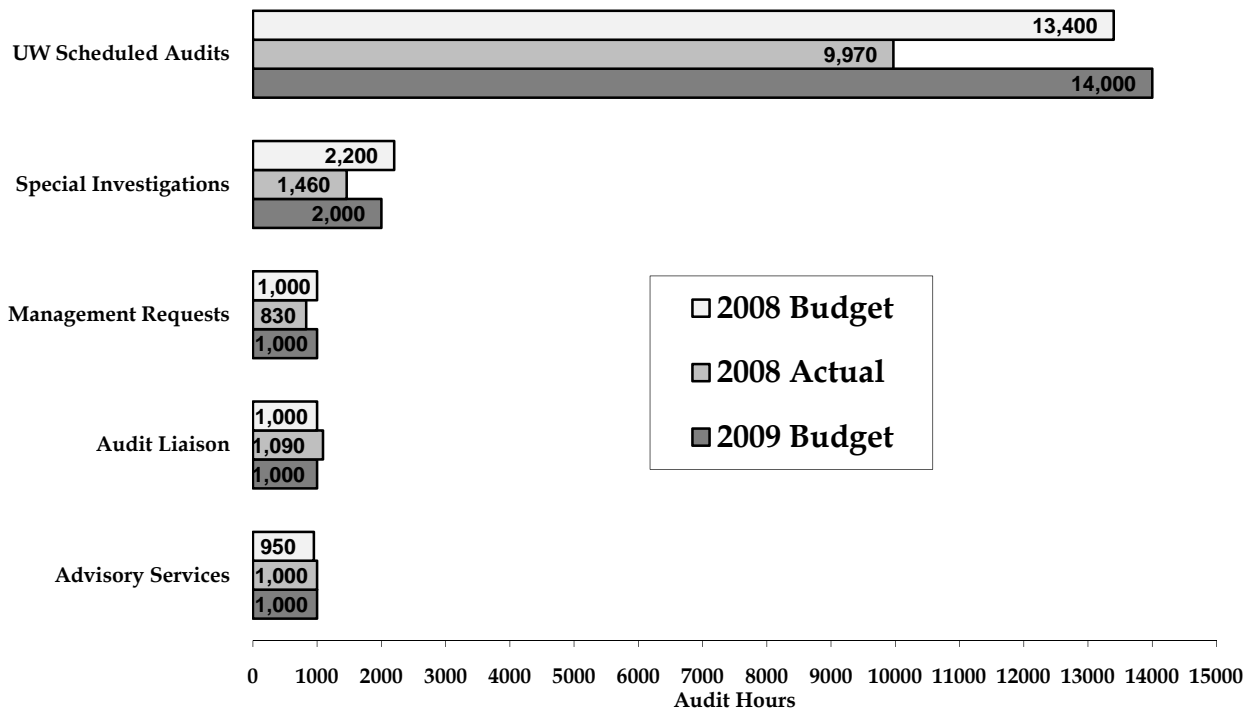

2009

Budget for scheduled audits increased in anticipation of a fully staffed audit department.

Summary of Audit Coverage

The University departments listed below are ranked from high to low in terms of the relative risk they represented based on the two year risk assessment performed by Internal Audit. The columns to the right identify the areas audited in 2008 or to be audited in 2009 by each respective audit entity.

Risk/ Rank	Organization	Internal Audit	State Auditor' s Office	KMPG	Peterson Sullivan	Other Auditors
1.	School of Medicine	•	•			○
2.	Harborview Medical Center	•	•	•		
3.	University Medical Center	•	•	•		
4.	College of Arts & Sciences	•				○
5.	UW Technology	•	•	•		
6.	Educational Outreach	•				
7.	Health Sciences	○				○
8.	School of Dentistry	•	•			
9.	School of Public Health & Community Medicine	•				
10.	Intercollegiate Athletics	•	•	•		
11.	Office of Development & Alumni Relations			•		
12.	Facilities Services	•		•		
13.	Bothell Campus	•				
14.	Capital Projects		•	•		
15.	Tacoma Campus	•				
16.	School of Nursing	•				
17.	Purchasing		•	•		
18.	College of Engineering					○
19.	School of Business Administration					
20.	College of Ocean & Fishery Sciences					○
21.	Payables Operations		•	•		
22.	Grant & Contract Accounting		•	•		○
23.	University Police		•			
24.	School of Pharmacy					
25.	Human Resources					
26.	University Libraries					
27.	Payroll		•	•		
28.	UW Tech Transfer					
29.	Office of Sponsored Programs		•			

• Plan to audit in 2009 ○ Audited in 2008

Summary of Audit Coverage (continued)

The University departments listed below are ranked from high to low in terms of the relative risk they represented based on the two year risk assessment performed by Internal Audit. The columns to the right identify the areas audited in 2008 or to be audited in 2009 by each respective audit entity.

Risk/ Rank	Organization	Internal Audit	State Auditor' s Office	KMPG	Peterson Sullivan	Other Auditors
30.	Student Publications	•			•	
31.	School of Law					
32.	School of Social Work					
33.	College of Forest Resources	○				○
34.	Student Fiscal Services		•	•		
35.	Treasury Office			•		
36.	Housing & Food Services		•		•	
37.	Graduate School					
38.	Financial Accounting		•	•		
39.	Real Estate/Metropolitan Tract Office				•	
40.	Office of Research		•			
41.	Office of Information Management					
42.	Minority Affairs					○
43.	Undergraduate Education	○				
44.	College of Built Environment					
45.	Daniel J. Evans School of Public Affairs					
46.	Transportation			•		
47.	Enrollment Services (Admissions & Registrar)	•	•			
48.	Student Financial Aid		•			
49.	College of Education					
50.	Equipment Inventory			•		○
51.	External Affairs					
52.	Provost					○
53.	Planning & Budgeting					
54.	Risk Management			•		
55.	Information School					
56.	Student Life					
57.	ASUW/GPSS				•	
58.	Student Activities and Union Facilities				•	

• Plan to audit in 2009 ○ Audited in 2008

Risk Assessment Methodology

We use a risk assessment model to prioritize audit coverage and ensure timely reviews of high exposure areas. We define risk to include:

- Loss, unauthorized use and misappropriation of University assets
- Violation of laws and regulations
- Adverse publicity involving the University

The risk assessment process includes gathering and evaluating information from senior management and college and department administrators, and utilizing the University's data warehouse for financial information. We use the following risk factors to help identify high risk areas.

- Business Exposure
- Compliance Requirements
- Control Environment Stability
- Audit Coverage
- Financial Impact
- Information Systems Complexity
- Management's Interest
- Auditor's Interest

We review risk assessment models used by peer institutions and utilize their experience and knowledge of university operations to ensure our risk assessment model includes factors relevant to the University of Washington.

We develop our two year audit plan based on the results of the risk assessment survey, management input, planned external audit coverage and issue currently affecting universities nationwide.

Elements of the Audit Planning Process

- Interviews of senior University management for key concerns
- University-wide assessment of risk
- Consideration of the changing environment and identification of issues that could affect the University
- Evaluation of issues of concern to other universities

Universities contacted:

University of Arizona
University of California – Berkeley
University of California – San Diego
University of California System
Colorado State University System
Cornell University
University of Florida
University of Georgia
Georgia Institute of Technology
University of Georgia System
University of Illinois – Urbana-Champaign
Johns Hopkins University
Massachusetts Institute of Technology
University of Michigan
University of Minnesota
University of New Mexico
University of North Carolina – Chapel Hill
Ohio State University
Oregon University System
University of Pennsylvania
Stanford University
Texas A&M University Systems
University of Texas System
University of Utah
University of Wisconsin – Madison

- Integrated planning with external auditors
- Assessment of cyclical audit coverage for high-risk organizational units identified in our risk assessment.

IV. REPORT OF THE CHAIR OF THE BOARD OF REGENTS

Regents Resolution Regarding Executive Order 29

Attachments: Board of Regents Resolution Regarding Faculty Salaries

Executive Order No. 29 of the President, March 31, 2009, *Partial
Suspension of Executive Order No. 64*

**University of Washington
Board of Regents
Resolution Regarding Faculty Salaries**

WHEREAS, the President and Faculty Senate worked together in 1999 and 2000 to create a Faculty Salary Policy which states, among other things, that Faculty members deemed in any year to be meritorious are to receive a two-percent pay increase in the following year; and

WHEREAS, the Board of Regents and the President remain committed to the achievement of fully competitive compensation for our faculty, but must contend with the current unprecedented condition of financial adversity; and

WHEREAS, in light of the effects of the global financial crisis and decreasing State support for the University, the President, after extensive review and consultation with the Faculty Senate in accordance with the Faculty Code, concluded he was compelled by fiscal necessity to issue, and has issued, a new Executive Order suspending the award of merit pay increases through the 2009-11 biennium.

NOW, THEREFORE, BE IT RESOLVED:

The Board of Regents:

1. Endorses the President's new Executive Order as a financial necessity and approves the suspension of merit pay increases through the 2009-11 biennium, which will prevail over any University policies, rules, or codes or regulations to the extent they may be inconsistent.
2. Directs that, through the period of such suspension, a copy of this resolution be inserted in the University Handbook at an appropriate location adjacent to the Faculty Salary Policy.
3. Requests that the President, with the Faculty Senate leadership, monitor the effects of this suspension and our current economic circumstance on competitive faculty compensation.
4. Requests the President to propose at the earliest possible opportunity the restoration of such faculty merit pay increases as may be feasible.

Executive Order No. 29 of the President, March 31, 2009.

Partial Suspension of Executive Order No. 64

Purpose. The purpose of this Executive Order is to address the immediate financial circumstances facing the University by temporarily controlling faculty salary levels while reaffirming the University's commitment to ensuring the quality of the University through a competitively compensated faculty dedicated to academic excellence.

Need for Temporary Reevaluation of Faculty Salary Policy. Executive Order No. 64 recognized that in the event of decreased State support, a reevaluation of the Faculty Salary Policy could prove necessary. Unfortunately, we face that contingency to a degree that could not have been predicted even a year ago. The nation and the state of Washington are experiencing the effects of a global financial crisis of historic proportions. One consequence of this financial crisis is a drastic reduction in the State budget, which is virtually certain to result in significant reductions in State support for the University. The expected reductions in State support, combined with other economic forces, will result in cuts to programs, increased tuition, and reduced access for students, lay-offs and non-renewal of personnel, as well as limitations on the University's ability to increase salaries for broad classes of its employees. The cost of maintaining regular merit increases for the 2009–11 biennium would be even more damaging in the midst of broad and dramatic budget cuts across the institution.

Partial Suspension of Executive Order No. 64. In light of the economic circumstances facing the University, the following portions of Executive Order No. 64 must be and are immediately suspended:

1. The phrase “regular merit” in the first sentence of the subsection entitled *Allocation Categories*.
2. The sentence that reads, “A faculty member who is deemed to be meritorious in performance shall be awarded a regular 2% merit salary increase at the beginning of the following academic year.”
3. The sentence that reads, “If deemed meritorious in the next year's review, the faculty member shall receive a regular 2% merit increase at the beginning of the following academic year.”
4. The phrase, “In addition to regular merit salary allocations,” in the sentence in the subsection entitled *Promotion*.

All other portions of Executive Order No. 64 remain in effect. This suspension shall expire at the conclusion of the 2009–11 biennium.

Reaffirmation of Principles and Commitment. Although the suspension of merit salary increases is a temporary imperative, it remains equally evident that regular merit increases, promotions, hiring, retention, and competitive compensation of faculty are critical to the long-term success of the University. University leadership remains steadfastly committed to the fundamental elements of Executive Order No. 64, and its principles and priorities are reaffirmed. As evidence of this commitment, the following steps, subject to State law or formal changes to University policy, will be taken to respect the principles of the salary policy in Sections 24-70 and 24-71 of the *Faculty Code* and the portions of Executive Order No. 64 that have not been suspended:

5. Regular merit increases will resume first priority for allocation of salary funds after this suspension expires;
6. Promotion increases will continue during the 2009–11 biennium;
7. If a dean or chancellor, following procedures consistent with Section 24-71 B.3 of the *Faculty Code*, determines that offering a retention salary increase is required, the dean or chancellor will be allowed to allocate to this purpose some of the funds remaining to it after undertaking budget cuts negotiated with the Provost;
8. No pool of funds will be set aside centrally by the Provost or President for the purpose of retention in academic units;
9. Faculty positions will only be filled to the extent necessary to fulfill the University's mission and vision;
10. During the 2009–11 biennium, the Provost will provide the Senate Committee on Planning and Budgeting quarterly reports to review the status of faculty recruitment and retention across the institution.

IV. REPORT OF THE CHAIR OF THE BOARD OF REGENTSAppointment of Special Committee on the Future of the Metropolitan TractRECOMMENDED ACTION:

It is the recommendation of the Chair that the Board of Regents approve the appointment of a special committee on the future of the Metropolitan Tract.

BACKGROUND:

Under the bylaws of the Board of Regents, the Board Chair may appoint special committees with the consent of the Board. Consistent with the Board's discussions, and with the President's encouragement at the meeting held on March 19, 2009, the Board Chair, Regent Craig Cole, proposes the creation of a Special Committee on the Future of the Metropolitan Tract. The Committee would consist of the Chair of the Board (ex-officio, non-voting except as needed for a quorum) and three Regents to be selected by the Chair each year at the usual time of committee reorganization.

Committee Mission:

To provide advice and consultation to the President and/or the President's designees, and to the Board of Regents, on strategic alternatives relating to the future of the Metropolitan Tract, while leaving oversight of the normal management and financial affairs of the Tract to the Finance, Audit, and Facilities Committee.



TO: Board of Regents

FROM: Craig Cole, Chair

DATE: April 20, 2009

SUBJECT: Appointment of Special Committee on the Future of the Metropolitan Tract

Pursuant to the authorization by the Board of Regents on April 16, 2009, the following are appointed to serve on the Special Committee on the Future of the Metropolitan Tract. Service is at the pleasure of the Board Chair:

Regent Jeff Brotman
Regent Sally Jewell
Regent Herb Simon

The Board Chair serves on the committee in an ex-officio capacity, in the same manner as with other committees of the Board of Regents.

From those Regents who expressed an interest in serving (all of whom are certainly qualified), I have selected those members whose terms do not expire in September, 2009. I hope this is acceptable to everyone.

Please call if you have any questions.

Mission of the Special Committee on the Future of the Metropolitan Tract

To provide advice and consultation to the President and/or the President's designees, and to the Board of Regents, on strategic alternatives relating to the future of the Metropolitan Tract, while leaving oversight of the normal management and financial affairs of the Tract to the Finance, Audit, and Facilities Committee.

May 4, 2009

From Craig Cole:

Upon the advice of the members of the committee, and with Jeff's kind agreement, Regent Brotman is hereby designated as the committee's chair.

cc: Mark Emmert, President
V'Ella Warren, Treasurer
Jack Johnson, Attorney General

Board of Regents
University of Washington

V. REPORT OF THE PRESIDENT

Budget Update

This will be an oral presentation.



Planning and Budgeting Brief

Date Prepared: April 16, 2009

Subject: **Update of Washington State Legislative Budget Process**

The Senate version of the 2009-2011 Washington State operating budget (PSSB 5600) has passed out of Senate Ways and Means with amendments favorable to higher education and the University of Washington. As amended; the key points for the University of Washington are:

- A reduction in state funding of 23% off of 2009-2011 maintenance level budget, mitigated with \$25 million of federal stimulus funding.
- Annual Increases in Resident Undergraduate Tuition of 14% for each year of the biennium coupled with provisions for a slight increase in return to aid.
- Local control of tuition for all non-residents, and resident academic and professional graduates.
- Authorization for fee increases subject to the provisions of Initiative I-960. These include summer quarter tuition, fee-based and self-sustaining degree and certificate programs, services and activity fees, student technology fees, course and lab fees, and other administrative fees.
- A slight decrease of 278FTE in budgeted enrollment from 38,626 FTE to 38,348 which is manageable within the funds provided.

The attached chart shows a comparison of the original Senate budget, the amended budget and the current House budget.

UP-1.1/204-09
4/16/09



Planning and Budgeting Brief

UW Budget Scenarios	Senate		Ammended Senate		House	
	\$	%	\$	%	\$	%
2007-09 Expenditures	792,417		792,417		792,417	
2009-11 Maintenance (BASE)	834,370		834,370		834,370	
Policy Changes						
OPERATING ATB					(226,648)	
Admin	(43,500)					
Research & PS	(31,490)					
Instruction & SS	(89,512)					
Federal Stim State Offset	(24,730)				(33,975)	
CUT SUBTOTAL	(189,232)	-23%	(189,232)	-23%	(260,623)	-31%
Revenue						
CAPITAL to Operating*	???				-	
Federal Stim Funding	24,730		24,730		33,975	
Tuition	64,500	7%	94,733	14%	94,733	10%
REV SUBTOTAL	89,230	11%	119,463	14%	128,708	15%
Net Reduction to UW Budget		-12%		-8%		-16%

(69,769)

Tuition Revenue in 8,9 and 10% scenarios is based on:

Undergraduate Resident	14%	FY10	FY11
Undergraduate Non-Res	5%	18,600	21,204
Academic Grad Res/Non-Res	7%	3,780	3,969
Professional Grad Res/Non-Res	10%	8,000	8,800
		30,380	33,973
Biennial total		94,733	

UP-1.1/204-09
4/16/09

V. REPORT OF THE PRESIDENT

Faculty Presentation: The New Science of Learning: What's the Brain Have to Do With It?

For information only.

PowerPoint presentation at the meeting.

Attachment: Biography of Patricia K. Kuhl, Ph.D.

BIOGRAPHY

Patricia K. Kuhl, Ph.D.

Dr. Patricia K. Kuhl holds the Bezos Family Foundation Endowed Chair in Early Childhood Learning and is Co-Director of the UW Institute for Learning and Brain Sciences, Director of the University of Washington's NSF Science of Learning Center, and Professor of Speech and Hearing Sciences at the University of Washington in Seattle. She is internationally recognized for her research on early language and bilingual brain development, and studies that show how young children learn. Dr. Kuhl's work has played a major role in demonstrating how early exposure to language alters the brain, and how early measures of the brain's response to language predict the course of language development. These data have implications for bilingual education and reading readiness, for early diagnosis of developmental disabilities such as autism, and for research on 'critical periods' in human development.



Dr. Kuhl is a member of the American Academy of Arts and Sciences, the Rodin Academy, and the Norwegian Academy of Science and Letters, and is a Fellow of the American Association for the Advancement of Science, the Acoustical Society of America, and the American Psychological Society. Dr. Kuhl was awarded the Silver Medal of the Acoustical Society of America in 1997, and in 2005, the Kenneth Craik Research Award from Cambridge University. She received the University of Washington's Faculty Lectureship Award in 1998. In 2007, Dr. Kuhl was awarded the University of Minnesota's Outstanding Achievement Award. In 2008, Dr. Kuhl was one of 30 scientists worldwide invited to present their work at a Nobel Symposium entitled, 'Brain, Genes, and Behavior'—she was the only scientist representing human development. In Paris in 2008, Dr. Kuhl was awarded the Gold Medal of the American Institute of Physics for her work on early learning and brain development.

Dr. Kuhl has participated in policy discussions related to education under two White House administrations. She was one of six scientists invited to the White House in 1997 to make a presentation at President and Mrs. Clinton's Conference on "Early Learning and the Brain." In 2001, Dr. Kuhl was invited to make a presentation at President and Mrs. Bush's White House Summit on "Early Cognitive Development: Ready to Read, Ready to Learn." In 2001, she co-authored *The Scientist in the Crib: Minds, Brains, and How Children Learn* (Morrow Press).

Dr. Kuhl's work has been widely covered by the media. She has appeared in the Discovery television series "The Baby Human"; the NOVA series "The Mind"; the "The Power of Ideas" on PBS; and "The Secret Life of the Brain," also on PBS. She has discussed her research findings on early learning and the brain on The Today Show, Good Morning America, CBS Evening News, NBC Nightly News, NHK, CNN, and in *The New York Times*, *Time*, and *Newsweek*.